



บริษัท เอดีดี เฟอร์เนส จำกัด

ADD FURNACE CO.,LTD.

44 ซอยบรมราชชนนี 70 ถนนบรมราชชนนี แขวงศาลาธรรมสพน์ เขตทวีวัฒนา กรุงเทพฯ 10170

โทร: 02-888-3472 โทร: ออกแบบ:08-08-170-170 แฟกซ์: 02-888-3258

https://www.add-furnace.com E-mail: sales@add-furnace.com

miT-uniD-cns ELECTRIC ACTUATOR

miT-uniD-cns

Certificate



ISO 9001:2008



CERTIFICATE OF REGISTRATION

THIS IS TO CERTIFY THAT THE QUALITY MANAGEMENT SYSTEM OF

PRO UNI-D CO., LTD.

No. 7, RUEIYUAN ST., BADE CITY, TAOYUAN COUNTY 33447, TAIWAN R.O.C.

Has been assessed and registered as complying with the requirements of the International Standard shown above for the following Goods and Services. Further clarifications regarding the scope of this certificate and the applicability of ISO 9001:2008 requirements may be obtained by consulting the organization.

Design and Manufacture of Solenoid Valves 1/8" - 4" and Motor Valves J4F-24". Previously Certified By ISC for ISO 9001:2000 on 16/May/2001.

ISC Pty Ltd, Unit 2/10 Gladstone Road, Carle Place NSW 2134, Sydney, Australia. This certificate is valid until the expiry date on the condition that audits are conducted and paid for as per the Certification Agreement. Should this condition not be met, cancellation procedures will be initiated and the client will be notified from the JAS ANZ system. This Certificate remains the property of International Standards Certification Pty Ltd and must be returned upon request. It must not be divided in any way. Intentional misuse of this certificate will result in cancellation without prior notification.

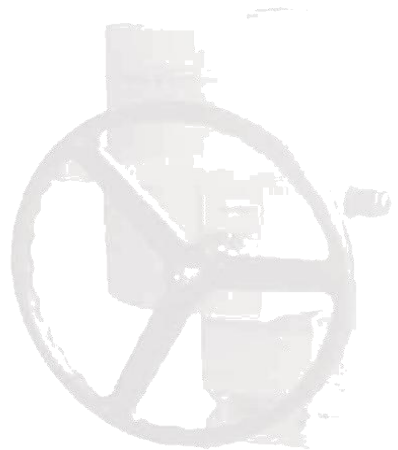

ISO 9001

ITS Intertek Testing Services ETL SEMKO VERIFICATION of conformity with European Directive(s) No. CE-0201490. Type of equipment: Valve Actuators. Document holder: Uni-D Corporation. Manufacturer: Uni-D Corporation. Type designation: EM-1, EM-2, EM-3. Technical data: 230V ac, 50/60Hz, Class, Type (R,F,P,20). A sample of the equipment has been tested for CE-marking according to the EC Directives... The referred test report(s) show that the product fulfills the requirements in the European Directives for CE marking.

CE

CSA INTERNATIONAL Certificate of Compliance Certificate: 13141960 Master Contract: 216808. Issued to: Uni-D Corporation. The products listed below are eligible to bear the CSA Mark shown, with adjunct indicator "C" and "US". PRODUCTS: CLASS 2211-02 - VALVES - Actuators. Motor control units for electrically operated valves, indoor, intermittent duty, one cycle in 3 minutes, Class A insulation, thermally protected, rated 120 V ac, 60 Hz.

CSA

IP67



UL 429 ISO 9001 Serial No : 216806



บริษัท เอดีดี เฟอร์เนส จำกัด

ADD FURNACE CO.,LTD.

44 ซอยบรมราชชนนี 70 ถนนบรมราชชนนี แขวงศาลาธรรมสพน์ เขตทวีวัฒนา กรุงเทพฯ 10170

โทร: 02-888-3472 โทร: ออกแบบ:08-08-170-170 แฟกซ์: 02-888-3258

https://www.add-furnace.com E-mail: sales@add-furnace.com

ELECTRIC ACTUATOR mit-uniD[®]-CNS

Suggested Actuator Model According to Valve Specification

UM Direct Mounting Series

Model	Valve size				Max Operating Pressure Diff Kgf/cm ²	Weight (KG)
	Screw End	Flange End	Butterfly Valve	3-Way Valve		
UMS	1/4" ~ 1/2"			1/4" ~ 3/8"	10	1
UM-1	1/4" ~ 1 1/2"	1/2" ~ 1"		1/2" ~ 1 1/2"	10	1.6
UM2-1	1" ~ 2"	1" ~ 1 1/2"	2" ~ 3"	1 1/4" ~ 1 1/2"	10	3.5
UM2-5	1" ~ 2"	1 1/4" ~ 2"	2" ~ 3"	1 1/4" ~ 1 1/2"	10	1.8
UM2-7	1" ~ 2"	1 1/4" ~ 2"	2" ~ 3"	1 1/4" ~ 1 1/2"	10	1.8
UM2-10	1" ~ 2 1/2"	1 1/4" ~ 2 1/2"	2" ~ 4"	1 1/4" ~ 2"	10	2.5
UM-3	1 1/4" ~ 3"	1 1/4" ~ 3"	2" ~ 5"	2 1/2"	10	4.5
UM-3-1	1 1/4" ~ 3"	1 1/4" ~ 3"	2" ~ 5"	2 1/2"	10	7.5
UM-4	20 sec 2" ~ 3"	1 1/4" ~ 3"	4" ~ 6"	2 1/2"	10	9.5
	30 sec 4"	4"	5" ~ 8"	2 1/2" ~ 3"	10	9.5
UM-5		4" ~ 5"	8" ~ 10"	3" ~ 4"	10	10
UM-6		5" ~ 6"	10" ~ 12"	4" ~ 5"	10	10

UM Series with Mounting Kit

Model	Valve size						Max Operating Pressure Diff Kgf/cm ²	Weight (KG)
	Screw End	Flange End	True Union Ball Valve (Plastic)	Butterfly Valve	3 Way Screw Ends	3 Way Flange Ends		
UMS	1/4" ~ 1/2"		1/2"		1/4" ~ 3/8"		10	1
UM-1	1/4" ~ 1 1/2"	1/2" ~ 1"	1/2" ~ 1 1/2"		1/2" ~ 1"	1/2" ~ 1"	10	2
UM2-1	1" ~ 2"	1 1/4" ~ 1 1/2"	1/2" ~ 2"	2" ~ 3"	1 1/4" ~ 1 1/2"	1"	10	4.5
UM2-5	1" ~ 2"	1 1/4" ~ 1 1/2"	1/2" ~ 2"	2" ~ 3"	1 1/4" ~ 1 1/2"	1"	10	2.2
UM2-7	1" ~ 2"	1 1/4" ~ 2"	1/2" ~ 2"	2" ~ 3"	1 1/4" ~ 1 1/2"	1 1/4" ~ 1 1/2"	10	2.2
UM2-10	1" ~ 2 1/2"	1 1/4" ~ 2 1/2"	2" ~ 2 1/2"	2" ~ 4"	1 1/4" ~ 2"	1 1/4" ~ 2"	10	3.5
UM-3	1 1/4" ~ 3"	1 1/4" ~ 3"	1 1/4" ~ 3"	2" ~ 4"	2 1/2"	1 1/2" ~ 2"	10	5
UM-3-1	1 1/4" ~ 3"	1 1/4" ~ 3"	1 1/4" ~ 3"	2" ~ 4"	2" ~ 2 1/2"	1 1/2" ~ 2"	10	8.5
UM-4	20 sec 2" ~ 3"	1 1/4" ~ 3"	1 1/4" ~ 3"	4" ~ 6"	2 1/2"	2 1/2"	10	10.5
	30 sec 4"	4"	4"	5" ~ 8"	2 1/2" ~ 3"	2 1/2" ~ 3"	10	10.5
UM-5		5"		8" ~ 10"	4"	4"	10	11
UM-6		6"		10" ~ 12"	5"	5"	10	11
UM-8		6" ~ 8"		12" ~ 14"	5" ~ 6"	5" ~ 6"	10	28
UM-10		8" ~ 10"		14" ~ 16"	8"	8"	10	28
UM-11		10" ~ 12"		16" ~ 18"	8"	8"	10	28
UM-12		12"		20" ~ 24"	8"	8"	10	62
UMB	UP and DOWN (Gate valve / Knife valve / Bellow valve / ball valve)						10	
UMD	1/4" ~ 4"	1/2" ~ 12"	1/2" ~ 4"	2" ~ 24"	1/2" ~ 8"	1/2" ~ 8"	10	

Pressure 0~10kgf/cm² :

- Formula For Ball Valve : Torque 0 ~ 1000kgf-cm x 1.5x / Torque 0 ~ 1000kgf-cm x 1.3x
- Formula For Butterfly Valve : Torque 0 ~ 1000kgf-cm x 1.5x / Torque 0 ~ 1000kgf-cm x 1.3x

Above general specification for reference only.
For special requirement, please contact us directly.



บริษัท เอดีดี เฟอร์เนส จำกัด

ADD FURNACE CO.,LTD.

44 ซอยบรมราชชนนี 70 ถนนบรมราชชนนี แขวงศาลาธรรมสพน์ เขตทวีวัฒนา กรุงเทพฯ 10170

โทร: 02-888-3472 โทร: ออกแบบ:08-08-170-170 แฟกซ์: 02-888-3258

https://www.add-furnace.com E-mail: sales@add-furnace.com

miT-UNID-cns ELECTRIC ACTUATOR

24VAC Specification

Model	Power	Speed 90° sec (60Hz)	Torque(±5%) kgf-cm 24VAC	24VAC	Weight (KG)	ISO 5211 Mounting Pattern
UMS	3~4W	23	90	170mA	1	F03/F05

110VAC/220VAC Specification

Model	Power	Speed 90° sec (60Hz)	Torque (±5%) kgf-cm 110VAC	Torque (±5%) kgf-cm 220VAC	AC 100V~120V (60Hz)	AC 200V~250V (60Hz)	Weight (KG)	ISO 5211 Mounting Pattern
UMS	3~4W	23	105	105	33mA	30mA	1	F03 / F05
UM-1	10W	1	75	80	0.6A	0.3A	1.6	F03/F04/F05/F07
UM-1	10W	5	181	214	0.6A	0.3A	1.6	F03/F04/F05/F07
UM-1	10W	10	350	362	0.6A	0.3A	1.6	F03/F04/F05/F07
UM-1	15W	1	127	132	0.7A	0.4A	1.6	F03/F04/F05/F07
UM-1	15W	10	410	432	0.7A	0.4A	1.6	F03/F04/F05/F07
UM2-1	15W	17	500	450	0.7A	0.4A	3.5	F05 / F07
UM2-5	15W	11	500	500	1.2A	0.4A	1.8	F03/F04/F05/F07
UM2-7	18W	11	700	700	1.1A	0.4A	1.8	F03/F04/F05/F07
UM2-10	15W	20	1000	1000	0.7A	0.5A	2.5	F04/F05/F07
UM-3	25W	1	294	350	0.6A	0.6A	4.5	F07
UM-3	25W	8	1486	1562	0.6A	0.6A	4.5	F07
UM-3	40W	1	369	405	0.9A	0.6A	4.5	F07
UM-3	60W	1	445	460	1.0A	0.7A	4.5	F07
UM-3-1	25W	1	294	350	0.6A	0.6A	7.5	F07
UM-3-1	25W	8	1486	1562	0.6A	0.6A	7.5	F07
UM-3-1	40W	1	369	405	0.9A	0.6A	7.5	F07
UM-3-1	60W	1	445	460	1.0A	0.7A	7.5	F07
UM-4	25W	20	2500	2500	0.8A	0.6A	9.5	F07 / F10
UM-4	25W	30	3118	3320	0.6A	0.6A	9.5	F07 / F10
UM-5	40W	30	4266	4873	0.9A	0.6A	10	F10 / F12
UM-6	60W	30	5689	6081	1.0A	0.7A	10	F10 / F12
UM-8	100W	37	11038	9296	1.2A	0.6A	28	F14 / F16
UM-10	100W	52	12060	13500	1.2A	0.6A	28	F14 / F16
UM-11	100W	65	15000	14500	1.2A	0.6A	28	F14 / F16
UM-12	100W	143	35000	35000	1.2A	0.6A	62	M16x165PCD

24VDC Specification

Model	Power	Speed 90° sec (60Hz)	Torque (±5%) kgf-cm DC24V	DC24V Current consumed when without valve loading	Weight (KG)	ISO 5211 Mounting Pattern
UM-1	10W	2.5	250	0.1A	1.6	F03/F04/F05/F07
UM-1	10W	15	400	0.1A	1.6	F03/F04/F05/F07
UM2-1	10W	27	600	0.3A	3.5	F05 / F07
UM2-7	10W	16	700	0.1A	1.8	F03/F04/F05/F07
UM2-10	10W	30	1000	0.1A	2.5	F04/F05/F07
UM-3	30W	1	500	0.5A	4.5	F07
UM-3	30W	8	1500	0.5A	4.5	F07
UM-3-1	30W	1	500	0.3A	7.5	F07
UM-3-1	30W	8	1500	0.3A	7.5	F07
UM-4	30W	20	2500	0.3A	9.5	F07 / F10
UM-4	30W	30	3500	0.5A	9.5	F07 / F10
UM-6	65W	30	6000	0.8A	11	F10 / F12

● The actuator must be upgraded one level if operating pressure is over 10Kgf/cm².

● The actuator must be upgraded one level when equipped with modulating controller or valve turned too tightly. ◦

Above values are for reference



บริษัท เอดีดี เฟอร์เนส จำกัด

ADD FURNACE CO.,LTD.

44 ซอยบรมราชชนนี 70 ถนนบรมราชชนนี แขวงศาลาธรรมสพน์ เขตทวีวัฒนา กรุงเทพฯ 10170

โทร: 02-888-3472 โทร: ออกแบบ:08-08-170-170 แฟกซ์: 02-888-3258

<https://www.add-furnace.com> E-mail: sales@add-furnace.com

ELECTRIC ACTUATOR mit-uniD-cns

General Description :

1. UM-1 to UM-6 provide direct mounting on ISO 5211 valves.
2. UM series electric actuator is low power consumption, high torque, high efficiency, excellent weatherproof heavy-duty motor.
3. All the joints on the housing are armed with waterproofing seal (IP67), which is applicable for use in outdoor environment.
4. Stabilized start speed to effectively avoid water hammering and prolong pipeline life.
5. For UM series, it is easy to view valve open/close position through mechanism position indicator on top or side window of actuator cover, or through wiring to control box to display signal lamp.
6. All models have Built-in thermal protection to prevent motor burning out.

Standard Voltage :

100VAC ~ 120VAC

200VAC ~ 250VAC

24VDC or other special voltage

Enclosure :

1. IP67 rated waterproof and dustproof.
2. Made of Nylon which has purpose of resisting against heat, acid, alkali, waterproof, dustproof.
3. Optional : Aluminum Alloy.

Cautions :

1. Please turn power off before manual operation or for maintenance to avoid parts broken or danger. When manual operating, 8m/m (not exceeding 10m/m) open end wrench, is recommended to use. Turn slightly firstly, and check whether it is turned too tightly to avoid valve deadly locked. Do not turn it brutally to prevent internal machine parts broken or damage.
Note: Do not use other tool to turn hand wheel, otherwise it will damage motor and valve.
2. Check waterproof O Ring and cable gland are secured tightly after wiring to prevent dusting or water contamination. (Suggested Minimum wire thickness is above 6Ø)
3. When more than one electric actuator is needed to operate simultaneously, please connect with the individual cables or installing independent relay for each actuator.
4. When manual operating, please note the position indicator can not exceed scale marking range to prevent internal machine parts damage.
(Modulator: Variable resistor impaired)

Valve :

UM series provide mounting on ISO 5211 valve or non ISO 5211 valve.

Option :

- Temp. controller
- Uncharged limit switch (max. 2 units)
- Heater (including thermal protector)
- Modulating controller
- Local control unit
- Relay
- Potentiometer (VR)

Approvals :

- ISO 9001
- CE
- CSA
- UL429
- IP67



บริษัท เอดีดี เฟอร์เนส จำกัด

ADD FURNACE CO.,LTD.

44 ซอยบรมราชชนนี 70 ถนนบรมราชชนนี แขวงศาลาธรรมสพน์ เขตทวีวัฒนา กรุงเทพฯ 10170

โทร: 02-888-3472 โทร: ออกแบบ:08-08-170-170 แฟกซ์: 02-888-3258

https://www.add-furnace.com E-mail: sales@add-furnace.com

miT-UNID[®]-cns ELECTRIC ACTUATOR

UMS Direct Mount series

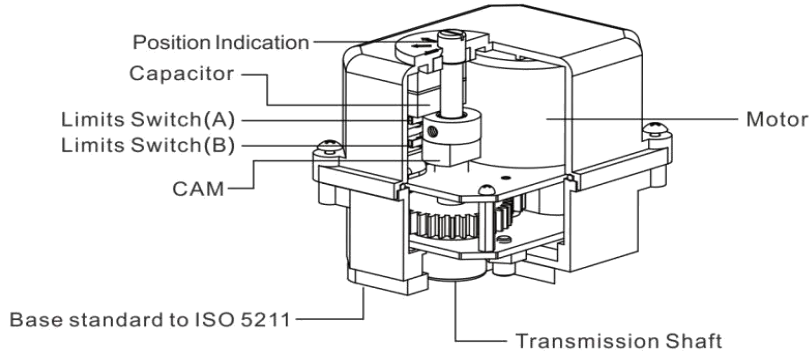

Weight : 1 kg

※The following values are subject to begin with 60Hz

Specification	Speed(sec)			Output Torque Kgf-cm				
	AC24V	AC110V	AC220V	AC	DC	AC24V	AC110V	AC220V
Power	AC24V	AC110V	AC220V	AC	DC	AC24V	AC110V	AC220V
3~4W	170mA	33mA	30mA	23	N/A	90	105	105

The Size Valve		
Screw End	True Union Ball Valve (Switch Kit Only)	3 WAY Flange End
1/4" ~ 1/2"	1/2"	1/4" ~ 3/8"

Action Interval:5 minutes per travel

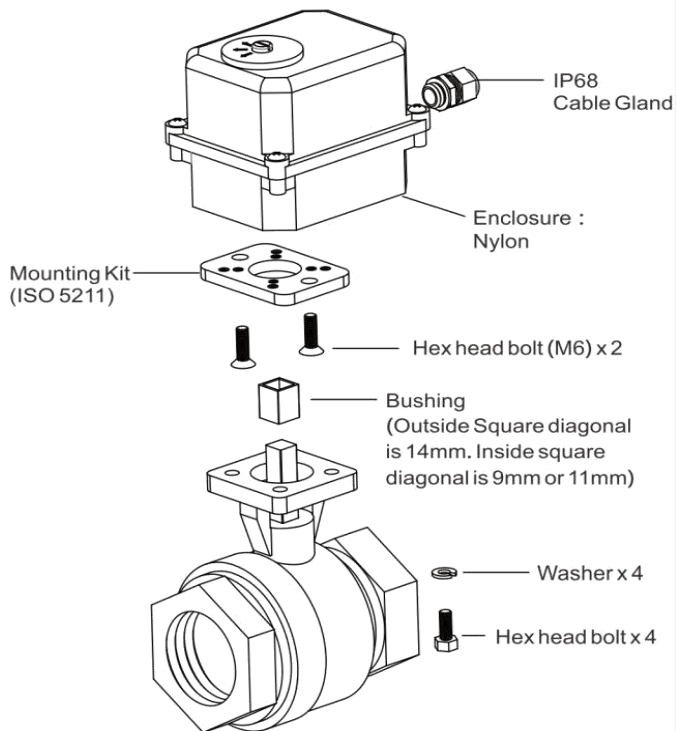

Mounting Pattern :

mounting kit	bore distance (P.C.D)	Hex head bolt size
	∅ 36 (P.C.D)	M5 × P0.8 × 12L
	∅ 50 (P.C.D)	M6 × P1.0 × 15L

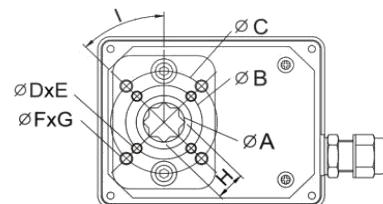
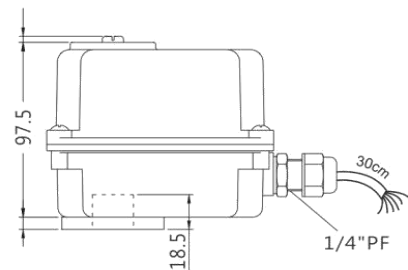
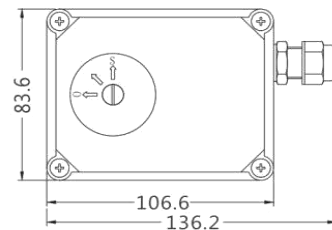

* Option : (1)H=□9,A=12 (2)H=□11,A=15

*F04/F07 D=M5, F=M8 Optional

Dimension (mm)	A	B	C	D	E	F	G	H	I	ISO 5211
Model								Max		
UMS	19.3	36	50	M5	4	M6	4	14	45°	F03/F05



บริษัท เอดีดี เฟอร์เนส จำกัด

ADD FURNACE CO.,LTD.

44 ซอยบรมราชชนนี 70 ถนนบรมราชชนนี แขวงศาลาธรรมสพน์ เขตทวีวัฒนา กรุงเทพฯ 10170

โทร: 02-888-3472 โทร: ออกแบบ:08-08-170-170 แฟกซ์: 02-888-3258

https://www.add-furnace.com E-mail: sales@add-furnace.com

ELECTRIC ACTUATOR miT-uniD-cns

UM-1 Direct Mount Series

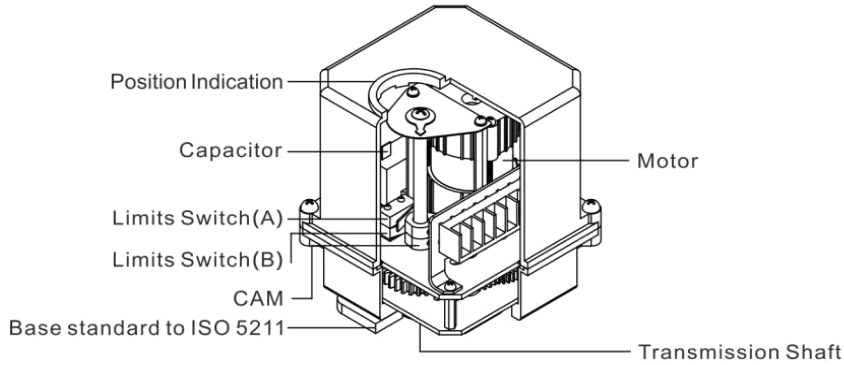

Weight : 1.6 kg

※The following values are subject to begin with 60Hz

Specification	Speed (sec)			Output Torque Kgf-cm				
	AC110V	AC220V	DC24V	AC	DC	AC110V	AC220V	DC24V
10W	0.6A	0.3A	0.1A	10	15	350	362	400
15W	0.7A	0.4A	N/A	10	N/A	410	432	N/A

Valve Size		
Screw End	Flange End	3-Way Valve
1/4" ~ 1 1/2"	1/2" ~ 1"	1/2" ~ 1 1/2"

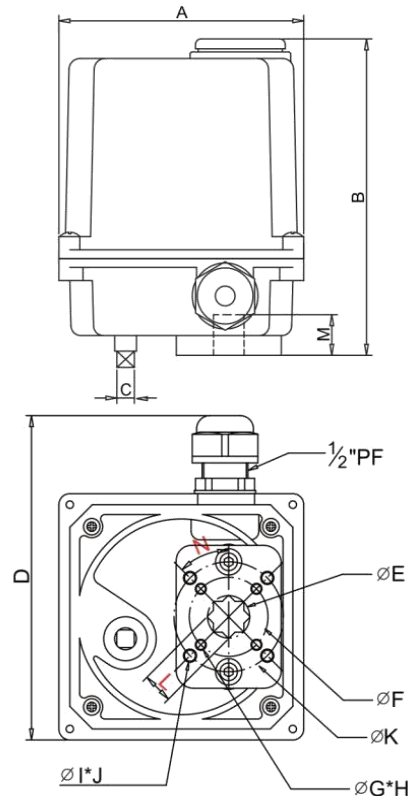
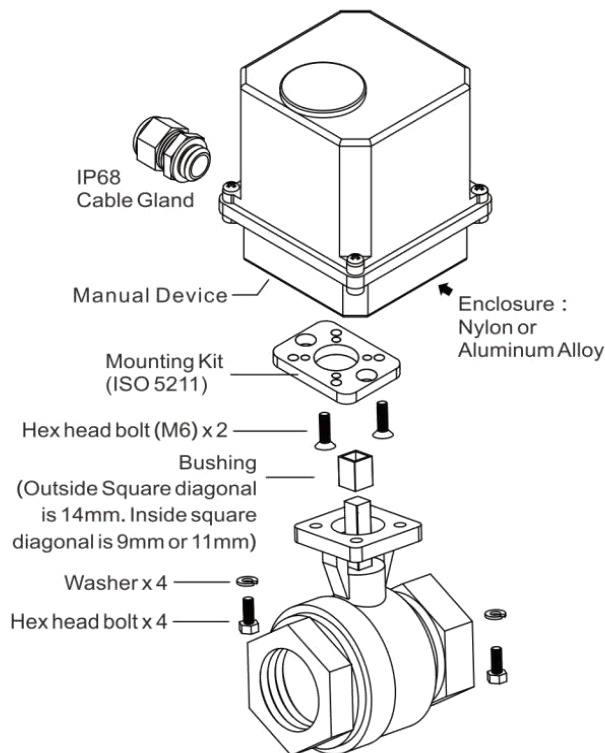

Dimension (mm)	Model														ISO 5211
	A	B	C	D	E	F	G	H	I	J	K	L Max	M	N	
UM-1	118	145	8	140	19.3	36	M5	4	M6	4	50	14.03	19	45	F03/F05

Action Interval:5 minutes per travel



บริษัท เอดีดี เฟอร์เนส จำกัด

ADD FURNACE CO.,LTD.

44 ซอยบรมราชชนนี 70 ถนนบรมราชชนนี แขวงศาลาธรรมสพน์ เขตทวีวัฒนา กรุงเทพฯ 10170

โทร: 02-888-3472 โทร: ออกแบบ:08-08-170-170 แฟกซ์: 02-888-3258

https://www.add-furnace.com E-mail: sales@add-furnace.com

ELECTRIC ACTUATOR **miT-uniD**-cns

UM2-1 Direct Mount Series

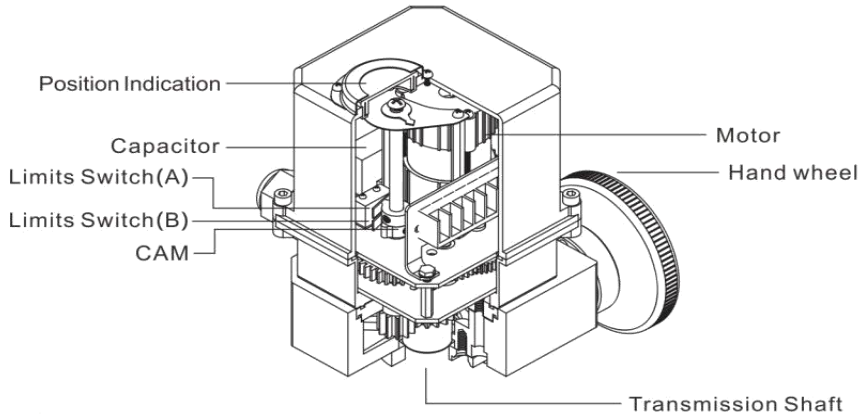

※The following values are subject to begin with 60Hz

Power	Specification			Speed (sec)		Output Torque Kgf-cm		
	AC110V	AC220V	DC24V	AC	DC	AC110V	AC220V	DC24V
15W	0.7A	0.4A	N/A	17	N/A	500	450	N/A
10W	N/A		0.3A	N/A	27	N/A		600

Valve Size			
Ball Valve Screw	Ball Valve Flange	Butterfly Valve	3-Way Valve
1" ~ 2"	1" ~ 1 1/2"	2" ~ 3"	1 1/4" ~ 1 1/2"



Weight : 3.5 kg

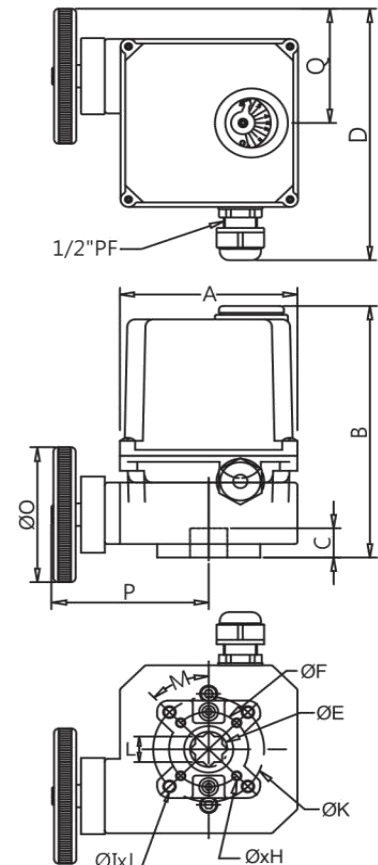
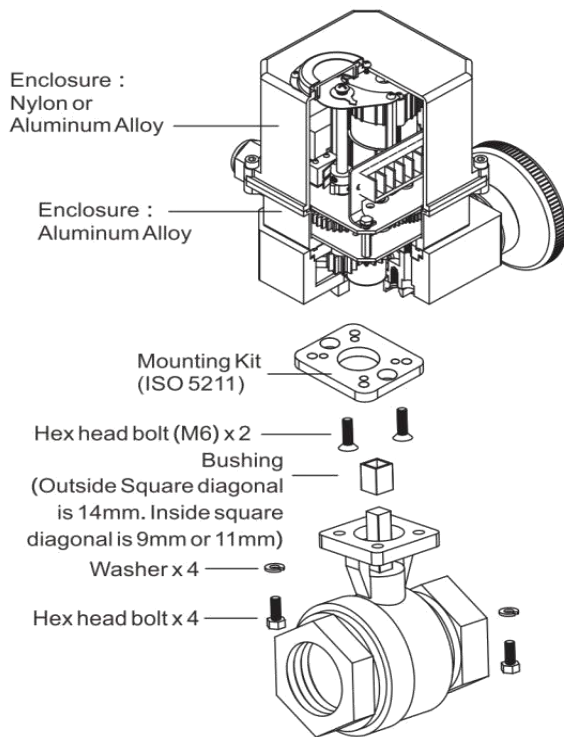

Dimension Model	Dimension (mm)														ISO 5211		
	A	B	C	D	E	F	G	H	I	J	K	L Max	M	O	P	Q	
UM2-1	117	185	19.2	148	23.5	50	M6	4	M8	4	70	17	45°	90	100	76	F05/F07

Action Interval:5 minutes per travel



บริษัท เอดีดี เฟอร์เนส จำกัด

ADD FURNACE CO.,LTD.

44 ซอยบรมราชชนนี 70 ถนนบรมราชชนนี แขวงศาลาธรรมสพน์ เขตทวีวัฒนา กรุงเทพฯ 10170

โทร: 02-888-3472 โทร: ออกแบบ:08-08-170-170 แฟกซ์: 02-888-3258

https://www.add-furnace.com E-mail: sales@add-furnace.com

miT-UNID-cns ELECTRIC ACTUATOR

UM2-5 UM2-7 Direct Mount Series

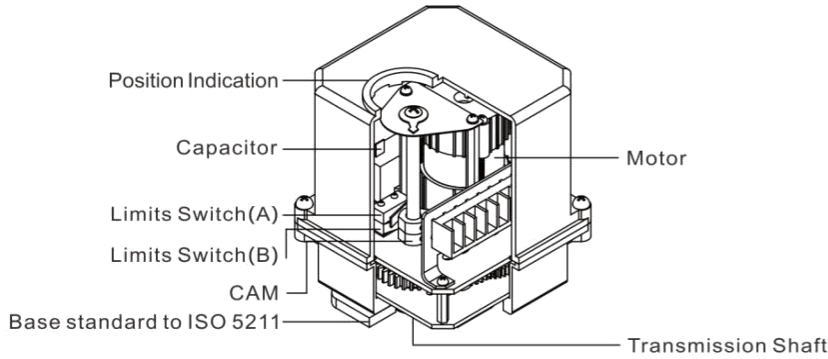

※The following values are subject to begin with 60Hz

Model	Specification				Speed (sec)		Output Torque Kgf-cm		
	Power	AC110V	AC220V	DC24V	AC	DC	AC110V	AC220V	DC24V
UM2-5	15W	1.2A	0.4A	N/A	11	N/A	500	500	N/A
UM2-7	18W	1.1A	0.4A	N/A	11	N/A	700	700	N/A
UM2-7	10W	N/A		0.1A	N/A	16	N/A		700

Valve Size			
Screw End	Flange End	Butterfly Valve	3-Way Valve
1" ~ 2"	1 1/4" ~ 2"	2" ~ 3"	1 1/4" ~ 1 1/2"

Weight : 1.8 kg

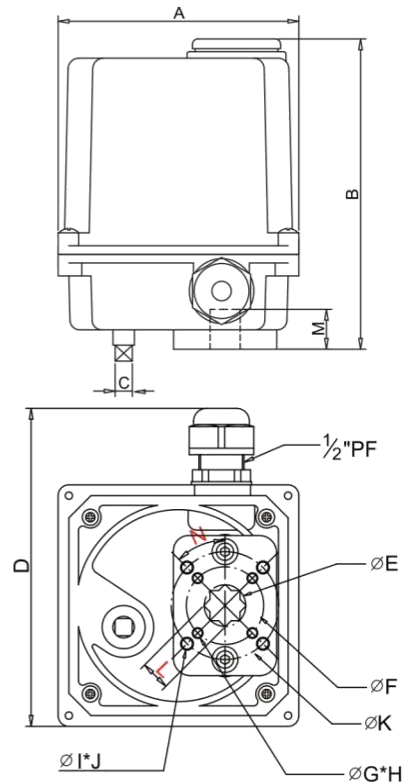
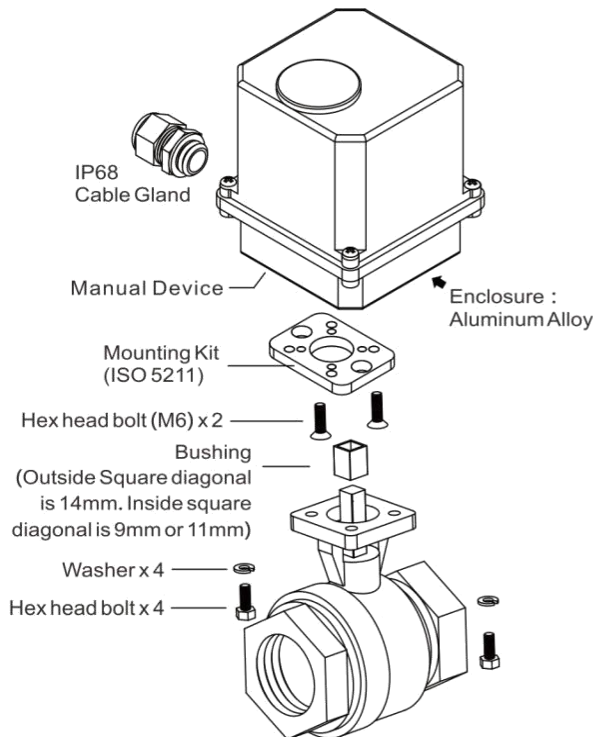

ISO 5211 F03/05
Optional : F05/07 or F04

Dimension Model	(mm)														ISO 5211
	A	B	C	D	E	F	G	H	I	J	K	L Max	M	N	
UM2-5/7	118	145	8	140	19.3	36	M5	4	M6	4	50	14.03	19	45	F03/F05

Action Interval:5 minutes per travel



บริษัท เอดีดี เฟอร์เนส จำกัด

ADD FURNACE CO.,LTD.

44 ซอยบรมราชชนนี 70 ถนนบรมราชชนนี แขวงศาลาธรรมสพน์ เขตทวีวัฒนา กรุงเทพฯ 10170

โทร: 02-888-3472 โทร: ออกแบบ:08-08-170-170 แฟกซ์: 02-888-3258

https://www.add-furnace.com E-mail: sales@add-furnace.com

miT-UNID-cms ELECTRIC ACTUATOR

UM2-10 Direct Mount Series

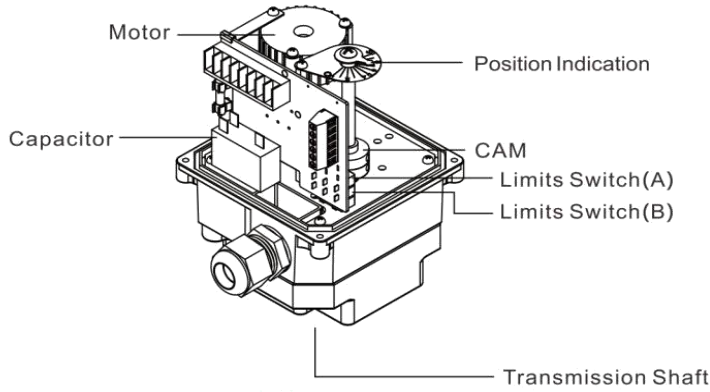

※The following values are subject to begin with 60Hz

Power	Specification			Speed (sec)		Output Torque Kgf-cm		
	AC110V	AC220V	DC24V	AC	DC	AC110V	AC220V	DC24V
15W	0.7A	0.5A	N/A	20	N/A	1000	1000	N/A
10W	N/A		0.1A	N/A	30	N/A		1000

Valve Size			
Ball Valve Screw	Ball Valve Flange	Butterfly Valve	3-Way Valve
1"~2 1/2"	1 1/4"~2 1/2"	2"~4"	1 1/4"~2"

Weight : 2.5 kg

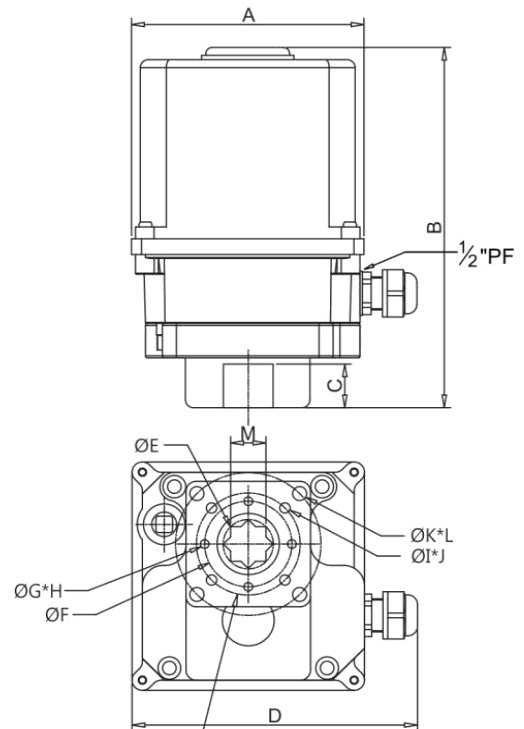
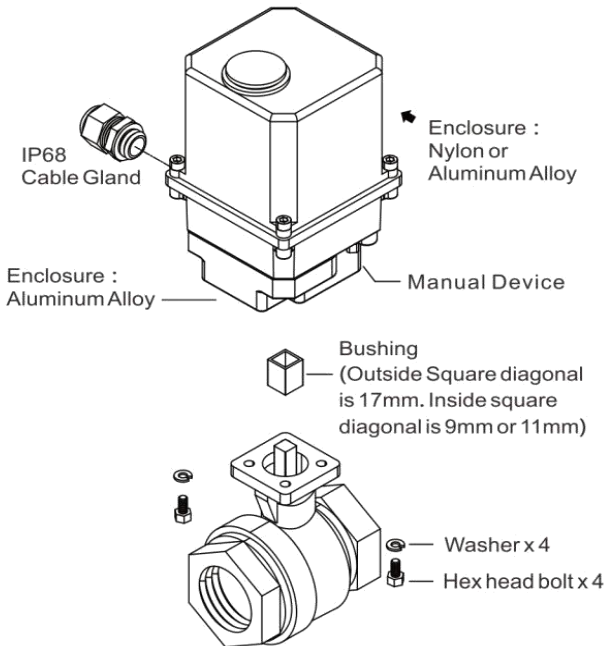

P.C.D ISO5211
 ISO 5211 F04 (Ø42 M5x10L)
 ISO 5211 F05 (Ø50 M6x12L)
 ISO 5211 F07 (Ø70 M8x15L)

Model	Dimension (mm)													ISO 5211
	A	B	C	D	E	F	G	H	I	J	K	L	M Max	
UM2-10	118	183.5	18	140	23.5	42	M5	4	M6	4	M8	4	17.15	F04/F05/F07

Action Interval:5 minutes per travel



บริษัท เอดีดี เฟอร์เนส จำกัด

ADD FURNACE CO.,LTD.

44 ซอยบรมราชชนนี 70 ถนนบรมราชชนนี แขวงศาลาธรรมสพน์ เขตทวีวัฒนา กรุงเทพฯ 10170

โทร: 02-888-3472 โทร: ออกแบบ:08-08-170-170 แฟกซ์: 02-888-3258

https://www.add-furnace.com E-mail: sales@add-furnace.com

mit-UNID-cns ELECTRIC ACTUATOR

UM-3 Direct Mount Series

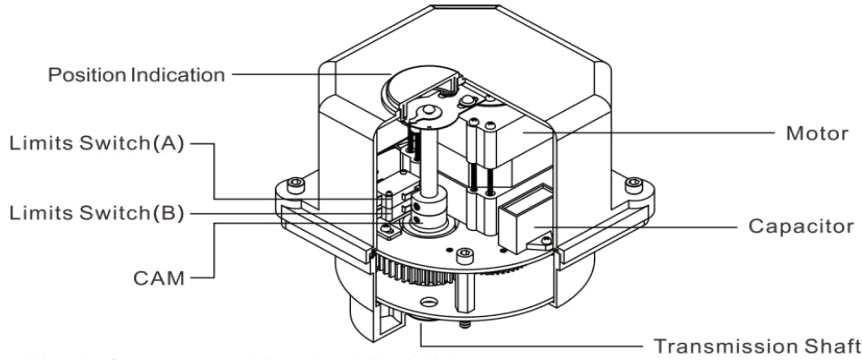

※The following values are subject to begin with 60Hz

Power	Specification			Speed(sec)		Output Torque Kgf-cm		
	AC110V	AC220V	DC24V	AC	DC	AC110V	AC220V	DC24V
25W	0.6A	0.6A	N/A	1	N/A	294	350	N/A
				8		1486	1562	
30W	N/A		0.5A	N/A	1	N/A		500
					8			1500
40W	0.9A	0.6A	N/A	1	N/A	369	405	N/A
60W	1.0A	0.7A	N/A	1	N/A	445	460	N/A

Valve Size			
Screw End	Flange End	Butterfly Valve	3-Way Valve
1 1/4" ~ 3"	1 1/4" ~ 3"	2" ~ 5"	2 1/2"



Weight : 4.5 kg

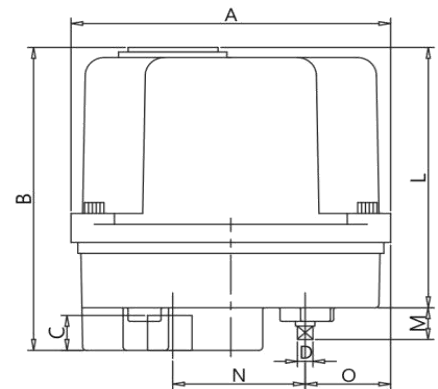
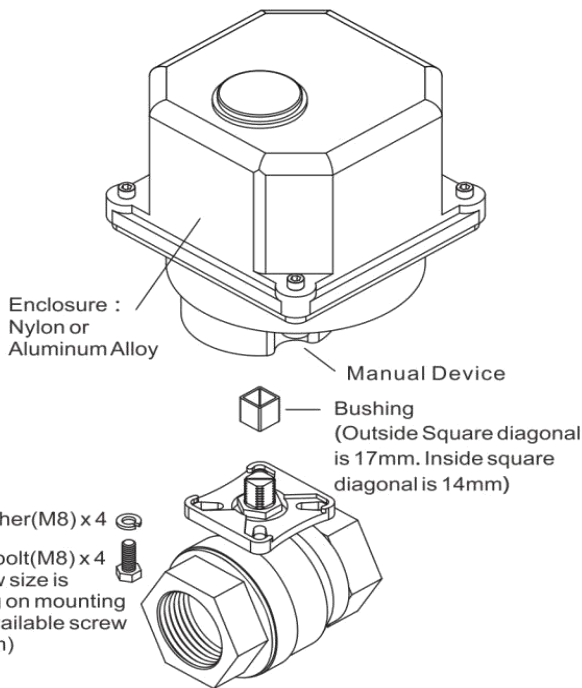

*The UM-3/24VDC is 26mm higher than standard one.

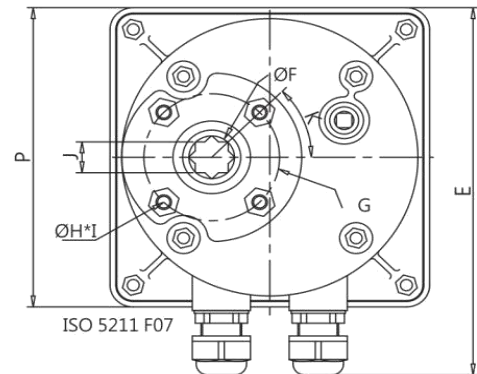

Action Interval:5 minutes per travel

Dimension Model	Dimension (mm)																ISO 5211
	A	B	C	D	E	F	G	H	I	J	K	L	M	N	O	P	
UM-3	165	172	20	8	203	23.5	70	M8	4	17	45°	148	17.3	68.4	44.2	165	F07



บริษัท เอดีดี เฟอร์เนส จำกัด

ADD FURNACE CO.,LTD.

44 ซอยบรมราชชนนี 70 ถนนบรมราชชนนี แขวงศาลาธรรมสพน์ เขตทวีวัฒนา กรุงเทพฯ 10170

โทร: 02-888-3472 โทร: ออกแบบ:08-08-170-170 แฟกซ์: 02-888-3258

https://www.add-furnace.com E-mail: sales@add-furnace.com

ELECTRIC ACTUATOR miT-uniD-cns

UM-3-1 Direct Mount Series

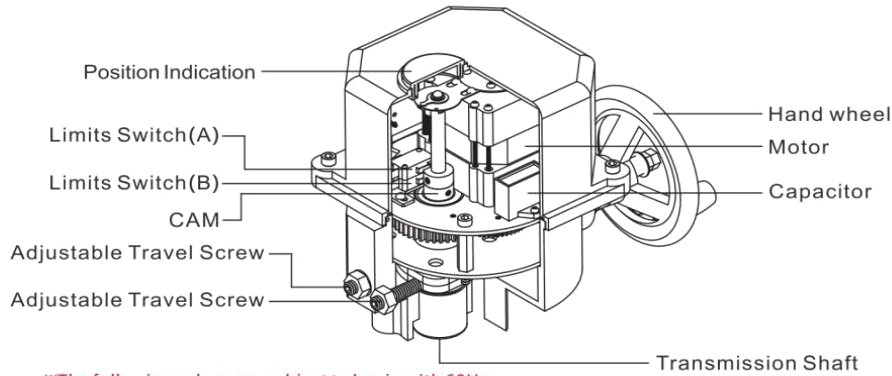

※The following values are subject to begin with 60Hz

Power	Specification			Speed (sec)		Output Torque Kgf-cm		
	AC110V	AC220V	DC24V	AC	DC	AC110V	AC220V	DC24V
25W	0.6A	0.6A	N/A	1	N/A	294	350	N/A
				8		1486	1562	
30W	N/A	0.3A	N/A	1	N/A	N/A	N/A	500
				8				1500
40W	0.9A	0.6A	N/A	1	N/A	369	405	N/A
60W	1.0A	0.7A	N/A	1	N/A	445	460	N/A

Valve Size			
Screw End	Flange End	Butterfly Valve	3-Way Valve
1 1/4" ~ 3"	1 1/4" ~ 3"	2" ~ 5"	2 1/2"



Weight : 7.5 kg

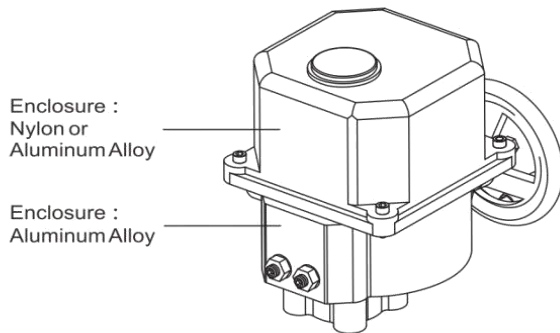

Bushing
(Outside Square diagonal is 17mm. —)
Inside square diagonal is 14mm)

Washer(M8) x 4

Hex head bolt(M8) x 4
(The screw size is depending on mounting pattern, available screw over 10mm)

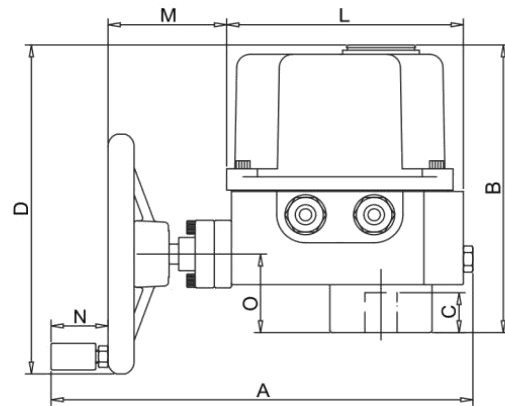
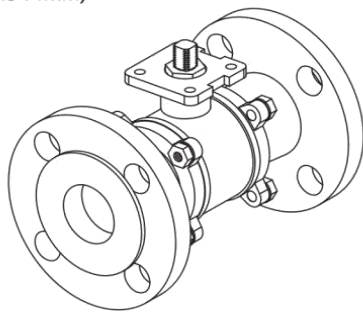

*The UM-3-1/24VDC 26mm higher than standard one.

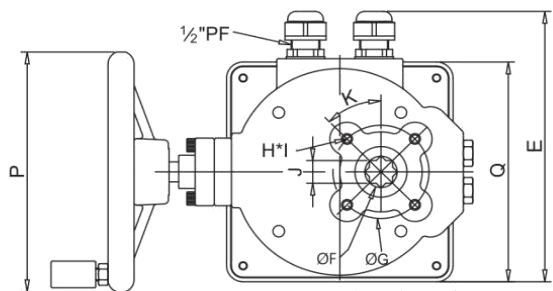

ISO 5211 F07

Dimension (mm)																ISO 5211		
	A	B	C	D	E	F	G	H	I	J	K	L	M	N	O		P	Q
UM-3-1	310	218	30	249	203	23.5	70	M8	4	17	45°	173	87	42	59	180	165	F07

Action Interval: 5 minutes per travel



บริษัท เอดีดี เฟอร์เนส จำกัด

ADD FURNACE CO.,LTD.

44 ซอยบรมราชชนนี 70 ถนนบรมราชชนนี แขวงศาลาธรรมสพน์ เขตทวีวัฒนา กรุงเทพฯ 10170

โทร: 02-888-3472 โทร: ออกแบบ:08-08-170-170 แฟกซ์: 02-888-3258

https://www.add-furnace.com E-mail: sales@add-furnace.com

miT-UNID[®]-cns ELECTRIC ACTUATOR

UM-4 Direct Mount Series

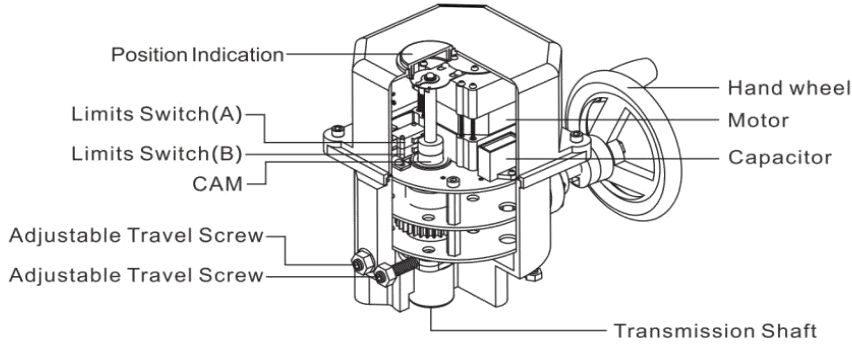

※The following values are subject to begin with 60Hz

Power	Specification			Speed (sec)		Output Torque Kgf-cm		
	AC110V	AC220V	DC24V	AC	DC	AC110V	AC220V	DC24V
25W	0.6A	0.6A	N/A	20	N/A	2500	2500	N/A
				30		3118	3320	
30W	N/A	0.5A	N/A	20	N/A	N/A	N/A	2500
				30				3500

Type	Valve Size			
	Screw End	Flange Ends	Butterfly Valve	3-Way Valve
20sec	2" ~ 3"	1 1/4" ~ 3"	4" ~ 6"	2 1/2"
30sec	4"	4"	5" ~ 8"	2 1/2" ~ 3"



Weight : 9.5 kg

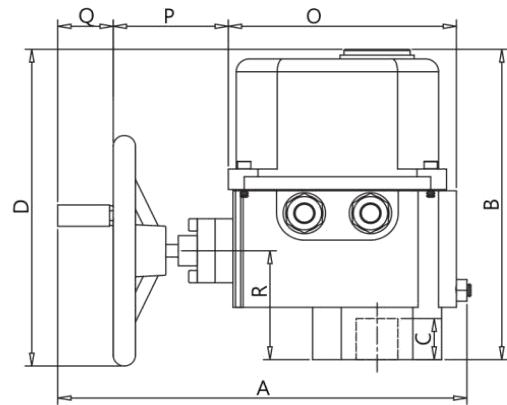
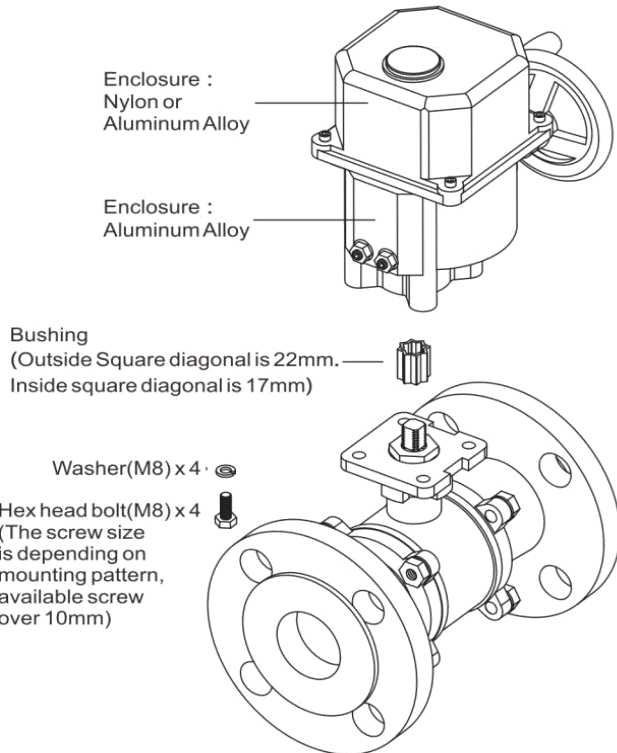

*The UM-4/24VDC is 26mm higher than standard one.

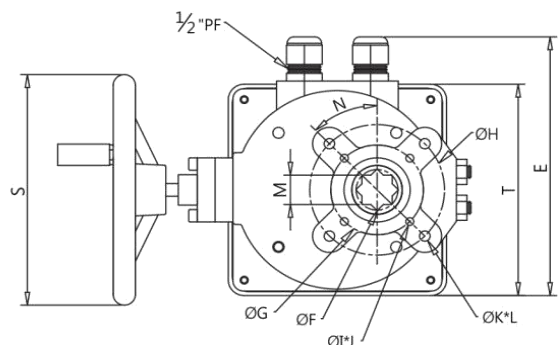

Dimension (mm)	A	B	C	D	E	F	G	H	I	J	K	L	M	N	O	P	Q	R	S	T	ISO 5211	
Model	UM-4	310	244	30	249	203	30.6	70	102	M8	4	M10	4	22	45	173	87	42	85	180	165	F07/F10

Action Interval: 5 minutes per travel



บริษัท เอดีดี เฟอร์เนส จำกัด

ADD FURNACE CO.,LTD.

44 ซอยบรมราชชนนี 70 ถนนบรมราชชนนี แขวงศาลาธรรมสพน์ เขตทวีวัฒนา กรุงเทพฯ 10170

โทร: 02-888-3472 โทร: ออกแบบ:08-08-170-170 แฟกซ์: 02-888-3258

https://www.add-furnace.com E-mail: sales@add-furnace.com

ELECTRIC ACTUATOR MIT-UNID-CNS

UM-5 UM-6 Direct Mount Series

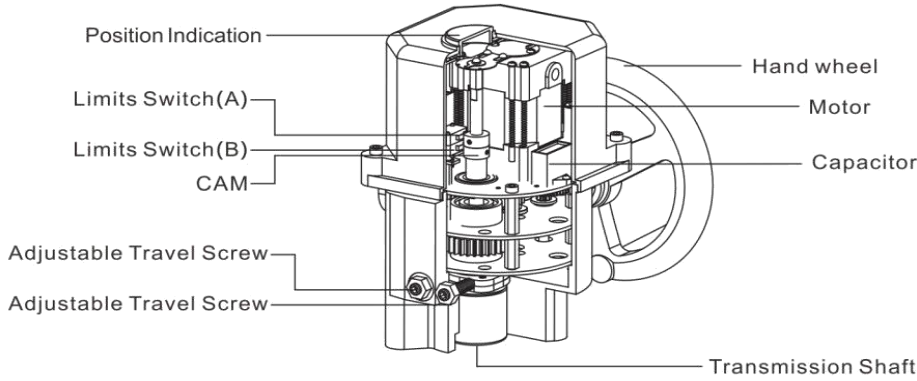

Weight : 10 kg

※The following values are subject to begin with 60Hz

Model	Specification				Speed (sec)		Output Torque Kgf-cm		
	Power	AC110V	AC220V	DC24V	AC	DC	AC110V	AC220V	DC24V
UM-5	40W	0.9A	0.6A	N/A	30	N/A	4266	4873	N/A
UM-6	60W	1.0A	0.7A	N/A	30	N/A	5689	6081	N/A
UM-6	65W	N/A		0.8A	N/A	30	N/A		6000

Model	Valve Size		
	Flange End	Butterfly Valve	3-Way Valve
UM-5	4 ~ 5"	8" ~ 10"	3" ~ 4"
UM-6	5" ~ 6"	10" ~ 12"	4" ~ 5"

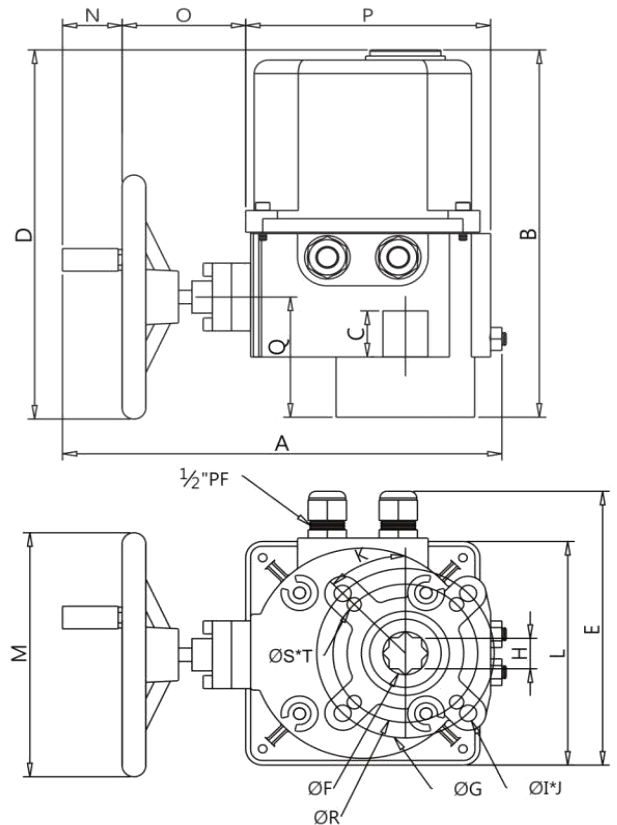
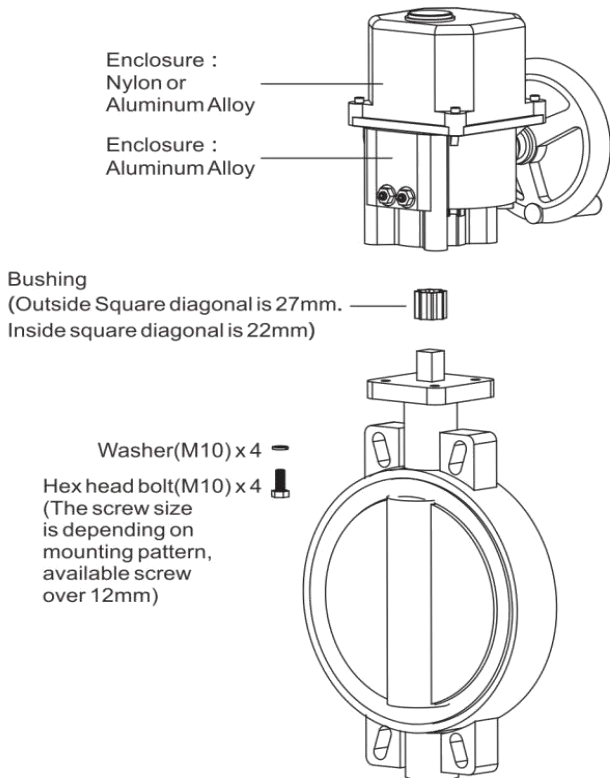

Dimension (mm)	A	B	C	D	E	F	G	H	I	J	K	L	M	N	O	P	Q	R	S	T	ISO 5211	
Model	UM-5/UM-6	310	276	34	274	203	36.5	125	27	M12	4	45°	165	180	42	87	173	92	102	M10	4	F10/F12

Action Interval: 5 minutes per travel



บริษัท เอดีดี เฟอร์เนส จำกัด

ADD FURNACE CO.,LTD.

44 ซอยบรมราชชนนี 70 ถนนบรมราชชนนี แขวงศาลาธรรมสพน์ เขตทวีวัฒนา กรุงเทพฯ 10170

โทร: 02-888-3472 โทร: ออกแบบ:08-08-170-170 แฟกซ์: 02-888-3258

https://www.add-furnace.com E-mail: sales@add-furnace.com

MIT-UNID-cns ELECTRIC ACTUATOR

UM-1 Series Mounting Kit Series

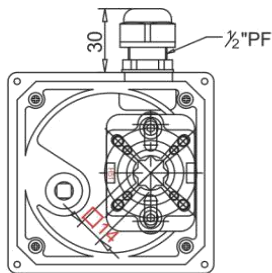
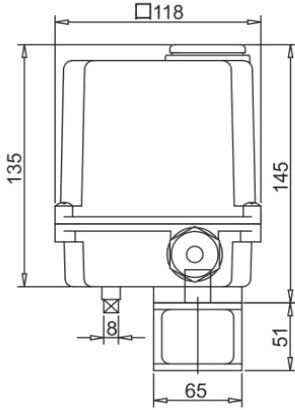

ISO 5211 F03/F04/F05/F07

Action Interval:5 minutes per travel



※The following values are subject to begin with 60Hz

Weight :2 kg

Power	Specification			Speed (sec)		Output Torque Kgf-cm		
	AC110V	AC220V	DC24V	AC	DC	AC110V	AC220V	DC24V
10W	0.6A	0.3A	0.1A	1	2.5	75	80	250
				5	15	181	214	400
				10		350	362	
15W	0.7A	0.4A	N/A	1	N/A	127	132	N/A
				10		410	432	

Valve Size				
Screw End	Flange End	True Union Ball Valve	3-Way Screw End	3-Way Flange End
1/4" ~ 1 1/2"	1/2" ~ 1"	1/2" ~ 1 1/2"	1/2" ~ 1"	1/2" ~ 1"

UM-2-1 Series Mounting Kit Series

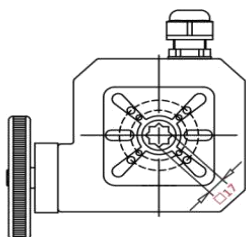
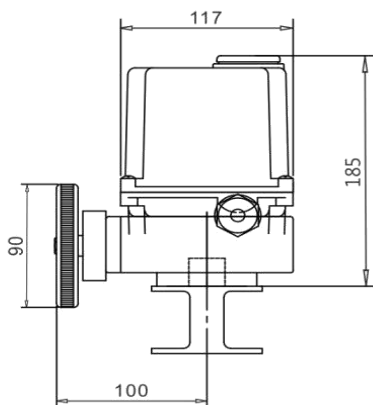

ISO 5211 F03/F05/F07

Action Interval:5 minutes per travel



※The following values are subject to begin with 60Hz

Weight :4.5 kg

Power	Specification			Speed (sec)		Output Torque Kgf-cm		
	AC110V	AC220V	DC24V	AC	DC	AC110V	AC220V	DC24V
15W	0.7A	0.4A	N/A	17	N/A	500	450	N/A
10W	N/A		0.3A	N/A	27	N/A		600

Valve Size					
Screw End	Flange End	True Union Ball Valve	Butterfly Valve	3-Way Screw End	3-Way Flange End
1" ~ 2"	1 1/4" ~ 1 1/2"	1/2" ~ 2"	2" ~ 3"	1 1/4" ~ 1 1/2"	1"

※For ordering actuator only, please provide transmission stem size of valve so as to connect actuator properly.



บริษัท เอดีดี เฟอร์เนส จำกัด

ADD FURNACE CO.,LTD.

44 ซอยบรมราชชนนี 70 ถนนบรมราชชนนี แขวงศาลาธรรมสพน์ เขตทวีวัฒนา กรุงเทพฯ 10170

โทร: 02-888-3472 โทร: ออกแบบ:08-08-170-170 แฟกซ์: 02-888-3258

https://www.add-furnace.com E-mail: sales@add-furnace.com

miT-UNID-cns ELECTRIC ACTUATOR

UM2-5 UM2-7 Series Mounting Kit Series

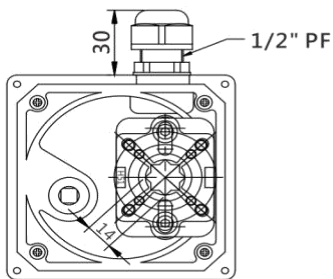
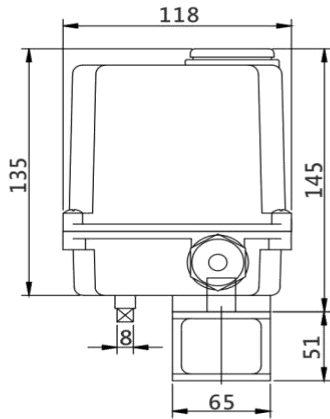

ISO 5211 F03 / F04 / F05 / F07

Action Interval:5 minutes per travel



Weight : 2 kg

※The following values are subject to begin with 60Hz

Model	Specification				Speed (sec)		Output Torque Kgf-cm		
	Power	AC110V	AC220V	DC24V	AC	DC	AC110V	AC220V	DC24V
UM2-5	15W	1.2A	0.4A	N/A	11	N/A	500	500	N/A
UM2-7	18W	1.1A	0.4A	N/A	11	N/A	700	700	N/A
UM2-7	10W	N/A		0.1A	N/A	16	N/A		

Valve Size					
Screw End	Flange End	True Union Ball Valve	Butterfly Valve	3-Way Screw End	3-Way Flange End
1" ~ 2"	1 1/4" ~ 2"	1/2" ~ 2"	2" ~ 3"	1 1/4" ~ 1 1/2"	1 1/4" ~ 1 1/2"

UM2-10 Series Mounting Kit Series

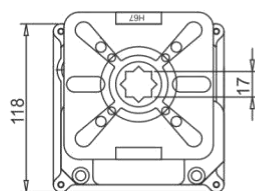
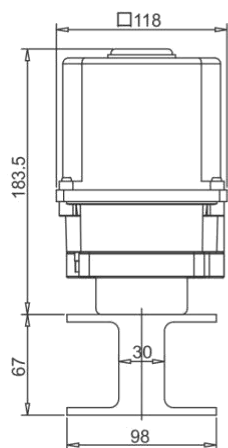

ISO 5211 F04/F05/F07

Action Interval:5 minutes per travel

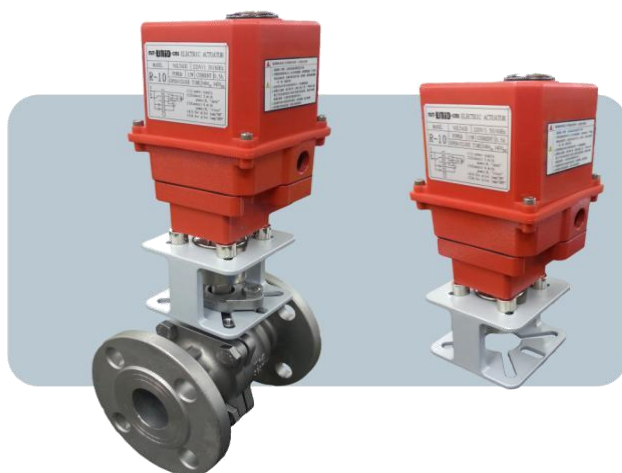

Weight : 3.5 kg

※The following values are subject to begin with 60Hz

Power	Specification			Speed (sec)		Output Torque Kgf-cm		
	AC110V	AC220V	DC24V	AC	DC	AC110V	AC220V	DC24V
15W	0.7A	0.5A	0.1A	20	N/A	1000	1000	N/A
10W	N/A		0.1A	N/A	30	N/A		

Valve Size					
Screw End	Flange End	True Union Ball Valve	Butterfly Valve	3-Way Screw End	3-Way Flange End
1" ~ 2 1/2"	1 1/4" ~ 2 1/2"	2" ~ 2 1/2"	2" ~ 4"	1 1/4" ~ 2"	1 1/4" ~ 2"

※For ordering actuator only, please provide transmission stem size of valve so as to connect actuator properly.



บริษัท เอดีดี เฟอร์เนส จำกัด

ADD FURNACE CO.,LTD.

44 ซอยบรมราชชนนี 70 ถนนบรมราชชนนี แขวงศาลาธรรมสพน์ เขตทวีวัฒนา กรุงเทพฯ 10170

โทร: 02-888-3472 โทร: ออกแบบ:08-08-170-170 แฟกซ์: 02-888-3258

https://www.add-furnace.com E-mail: sales@add-furnace.com

ELECTRIC ACTUATOR mit-uniD-cns

UM-3 Series Mounting Kit Series

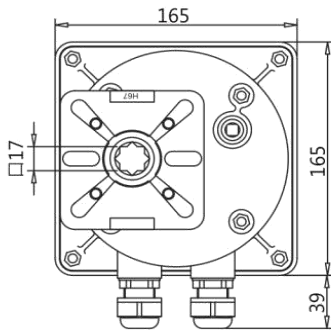
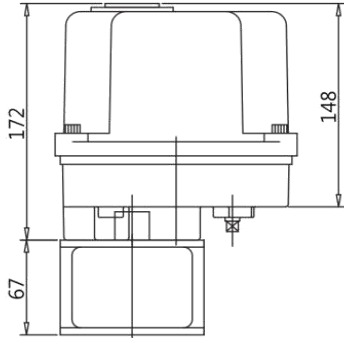

ISO 5211 F07/F10



Action Interval:5 minutes per travel

※The following values are subject to begin with 60Hz

Weight : 5 kg

Power	Specification			Speed (sec)		Output Torque Kgf-cm		
	AC110V	AC220V	DC24V	AC	DC	AC110V	AC220V	DC24V
25W	0.6A	0.6A	N/A	1	N/A	294	350	N/A
				8		1486		
30W	N/A		0.5A	N/A	1	N/A		500
					8			1500
40W	0.9A	0.6A	N/A	1	N/A	369	405	N/A
60W	1.0A	0.7A	N/A	1	N/A	445	460	N/A

Type	Valve Size					
	Screw End	Flange End	True Union Ball Valve	Butterfly Valve	3-Way Screw End	3-Way Flange End
1 sec	1 1/4" ~ 2"	1 1/4" ~ 2"	1 1/2" ~ 2"	2" ~ 2 1/2"	1 1/4" ~ 2"	
8 sec	1 1/4" ~ 3"	1 1/4" ~ 3"	1 1/4" ~ 3"	2" ~ 4"	2 1/2"	1 1/2" ~ 2"

UM-3-1 Series Mounting Kit Series

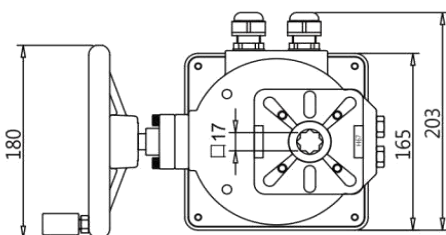
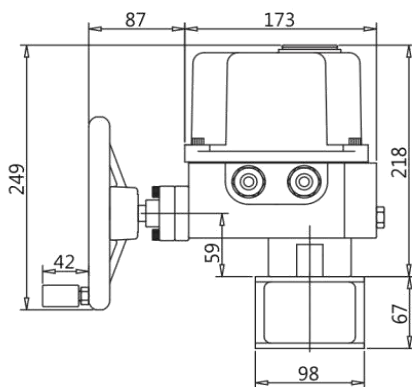

ISO 5211 F07/F10



Action Interval:5 minutes per travel

※The following values are subject to begin with 60Hz

Weight : 8.5 kg

Power	Specification			Speed (sec)		Output Torque Kgf-cm		
	AC110V	AC220V	DC24V	AC	DC	AC110V	AC220V	DC24V
25W	0.6A	0.6A	N/A	1	N/A	294	350	N/A
				8		1486		
30W	N/A		0.3A	N/A	1	N/A		500
					8			1500
40W	0.9A	0.6A	N/A	1	N/A	369	405	N/A
60W	1.0A	0.7A	N/A	1	N/A	445	460	N/A

Type	Valve Size					
	Screw End	Flange Ends	True Union Ball Valve	Butterfly Valve	3-Way Screw End	3-Way Flange End
1 sec	1 1/4" ~ 2"	1 1/4" ~ 2"	1 1/2" ~ 2"	2" ~ 2 1/2"	1 1/4" ~ 2"	
8 sec	1 1/4" ~ 3"	1 1/4" ~ 3"	1 1/4" ~ 3"	2" ~ 4"	2" ~ 2 1/2"	1 1/2" ~ 2"

※For ordering actuator only, please provide transmission stem size of valve so as to connect actuator properly.



บริษัท เอดีดี เฟอร์เนส จำกัด

ADD FURNACE CO.,LTD.

44 ซอยบรมราชชนนี 70 ถนนบรมราชชนนี แขวงศาลาธรรมสพน์ เขตทวีวัฒนา กรุงเทพฯ 10170

โทร: 02-888-3472 โทร: ออกแบบ:08-08-170-170 แฟกซ์: 02-888-3258

https://www.add-furnace.com E-mail: sales@add-furnace.com

MIT-UNID-CNS ELECTRIC ACTUATOR

UM-4 Series Mounting Kit Series

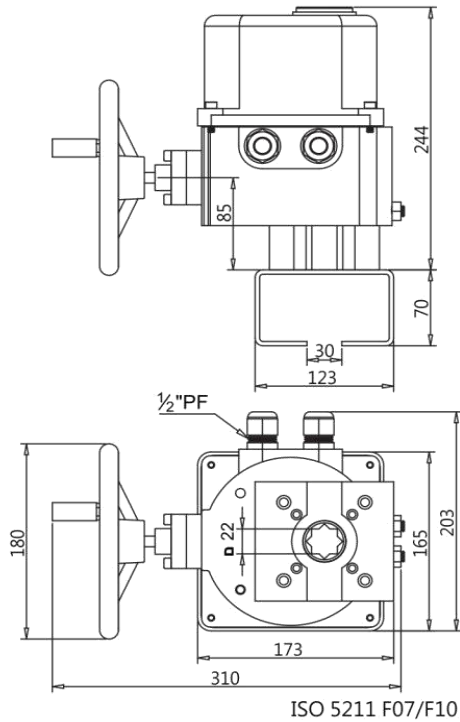

ISO 5211 F07/F10



Action Interval:5 minutes per travel

※The following values are subject to begin with 60Hz

Weight : 10.5 kg

Power	Specification			Speed (sec)		Output Torque Kgf-cm		
	AC110V	AC220V	DC24V	AC	DC	AC110V	AC220V	DC24V
25W	0.6A	0.6A	N/A	20	N/A	2500	2500	N/A
				30		3118	3320	
30W	N/A		0.5A	N/A	20	N/A		2500
				N/A	30			3500

Type	Valve Size					
	Screw End	Flange End	True Union Ball Valve	Butterfly Valve	3-Way Screw End	3-Way Flange End
20 sec	2" ~ 3"	1 1/4" ~ 3"	1 1/4" ~ 3"	4" ~ 6"	2 1/2"	2 1/2"
30 sec	4"	4"	4"	5" ~ 8"	2 1/2" ~ 3"	2 1/2" ~ 3"

UM-5 Series Mounting Kit Series

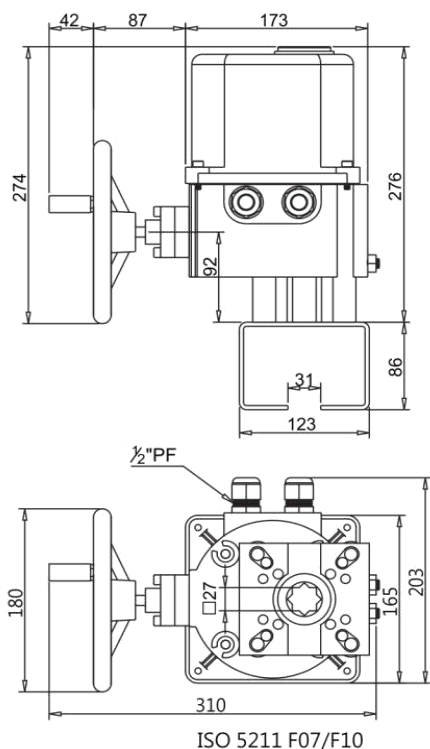

ISO 5211 F07/F10



Action Interval:5 minutes per travel

※The following values are subject to begin with 60Hz

Weight : 11 kg

Power	Specification			Speed (sec)		Output Torque Kgf-cm		
	AC110V	AC220V	DC24V	AC	DC	AC110V	AC220V	DC24V
40W	0.9A	0.6A	N/A	30	N/A	4266	4873	N/A

Valve Size			
Flange End	Butterfly Valve	3-Way Screw End	3-Way Flange End
5"	8" ~ 10"	4"	4"

※For ordering actuator only, please provide transmission stem size of valve so as to connect actuator properly.



บริษัท เอดีดี เฟอร์เนส จำกัด

ADD FURNACE CO.,LTD.

44 ซอยบรมราชชนนี 70 ถนนบรมราชชนนี แขวงศาลาธรรมสพน์ เขตทวีวัฒนา กรุงเทพฯ 10170

โทร: 02-888-3472 โทร: ออกแบบ:08-08-170-170 แฟกซ์: 02-888-3258

https://www.add-furnace.com E-mail: sales@add-furnace.com

ELECTRIC ACTUATOR **miT-uniD**-cns

UM-6 Series Mounting Kit Series

Action Interval:5 minutes per travel

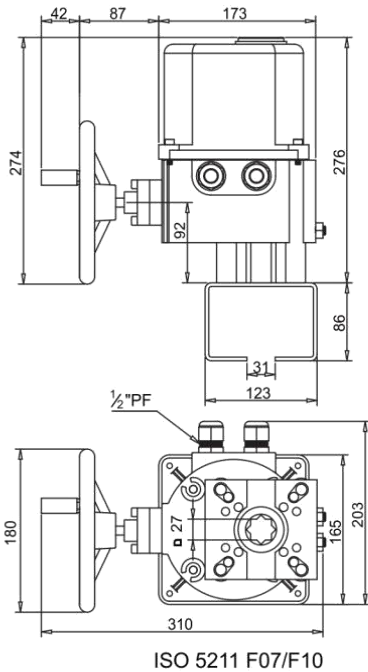

※The following values are subject to begin with 60Hz

Weight : 11 kg

Power	Specification			Speed (sec)		Output Torque Kgf-cm		
	AC110V	AC220V	DC24V	AC	DC	AC110V	AC220V	DC24V
60W	1.0A	0.7A	N/A	30	N/A	5689	6081	N/A
65W	N/A		0.8A	N/A	30	N/A		6000

Valve Size			
Flange Ends	Butterfly Valve	3-Way Screw End	3-Way Flange End
6"	10" ~ 12"	5"	5"

※For ordering actuator only, please provide transmission stem size of valve so as to connect actuator properly.

4-20mA Modulating controller

Features:

1. High precision micro-computer digital meter
2. Stepless adjustment: 4.0 ~ 20.0mA
3. Pointer display of valve position

Specification :

1. Dimension : Depth 160mm X Width 285mm X Height 115mm
2. Standard Voltage : 110VAC, 220VAC
3. Output signal : 4.0 ~ 20.0mA
4. Option : Please contact us for special requirement





บริษัท เอดีดี เฟอร์เนส จำกัด

ADD FURNACE CO.,LTD.

44 ซอยบรมราชชนนี 70 ถนนบรมราชชนนี แขวงศาลาธรรมสพน์ เขตทวีวัฒนา กรุงเทพฯ 10170

โทร: 02-888-3472 โทร: ออกแบบ:08-08-170-170 แฟกซ์: 02-888-3258

https://www.add-furnace.com E-mail: sales@add-furnace.com

MIT-UNID-cns ELECTRIC ACTUATOR

UM-8 UM-10 UM-11 Series Mounting Kit Series

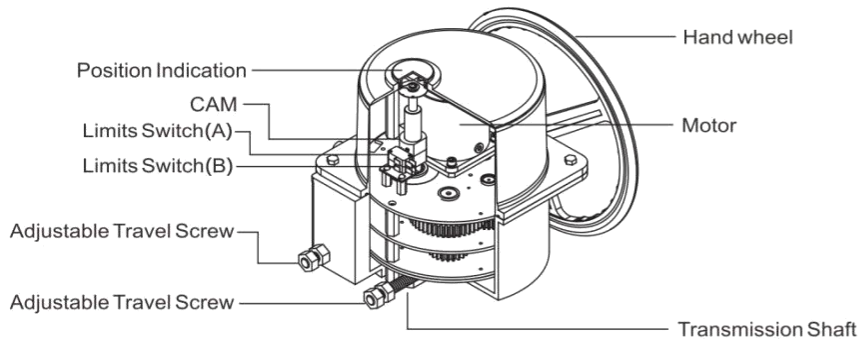

Weight : 28 kg

※The following values are subject to begin with 60Hz

Model	Specification			Speed (sec)	Output Torque Kgf-cm	
	Power	AC110V	AC220V	AC	AC110V	AC220V
UM-8	100W	1.2A	0.6A	37	11038	9296
UM-10	100W	1.2A	0.6A	52	12060	13500
UM-11	100W	1.2A	0.6A	65	15000	14500

Model	Valve Size			
	Flange End	Butterfly Valve	3-Way Screw End	3-Way Flange End
UM-8	6" ~ 8"	12" ~ 14"	5" ~ 6"	5" ~ 6"
UM-10	8" ~ 10"	14" ~ 16"	8"	8"
UM-11	10" ~ 12"	16" ~ 18"	8"	8"

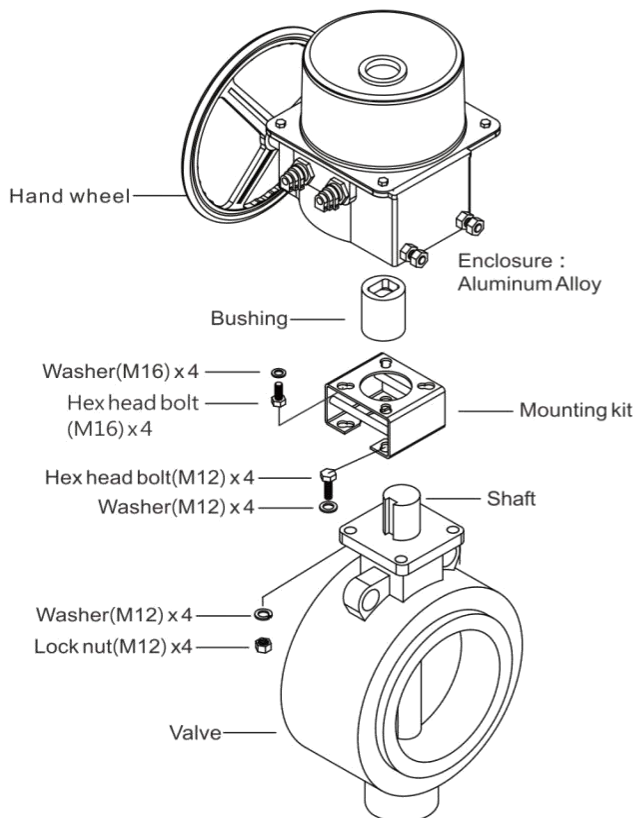

Action Interval:5 minutes per travel

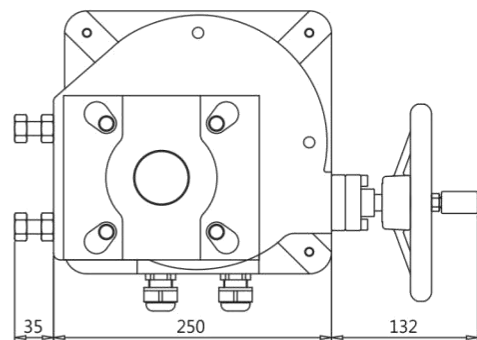
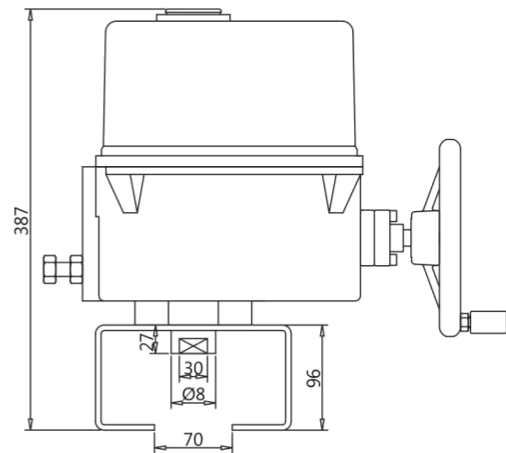

ISO 5211 F14/F16

※For ordering actuator only, please provide transmission stem size of valve so as to connect actuator properly.



บริษัท เอดีดี เฟอร์เนส จำกัด

ADD FURNACE CO.,LTD.

44 ซอยบรมราชชนนี 70 ถนนบรมราชชนนี แขวงศาลาธรรมสพน์ เขตทวีวัฒนา กรุงเทพฯ 10170

โทร: 02-888-3472 โทร: ออกแบบ:08-08-170-170 แฟกซ์: 02-888-3258

https://www.add-furnace.com E-mail: sales@add-furnace.com

ELECTRIC ACTUATOR **MIT-UNID-CRS**

UM-12 Series Mounting Kit Series

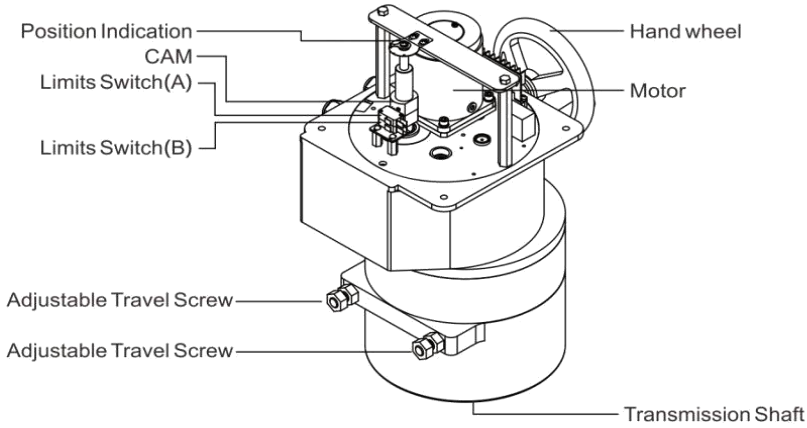

Weight : 62 kg

Specification	Speed (sec)				Output Torque Kgf-cm		
	AC110V	AC220V	AC	DC	AC110V	AC220V	DC24V
Power	1.2A	0.6A	143	N/A	35000	35000	N/A

Valve Size			
Flange End	Butterfly Valve	3-Way Screw End	3-Way Flange End
12"	20" ~ 24"	8"	8"

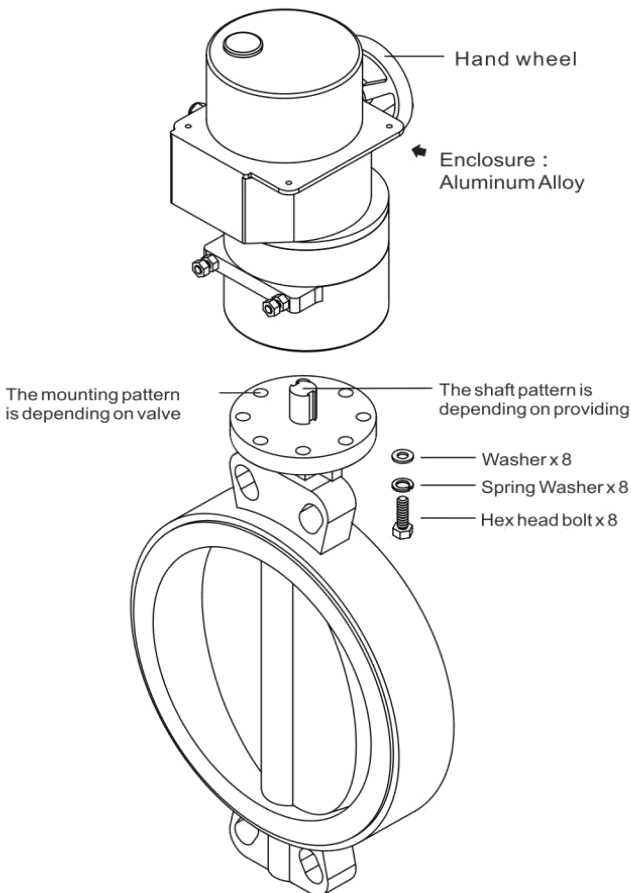

Action Interval:5 minutes per travel

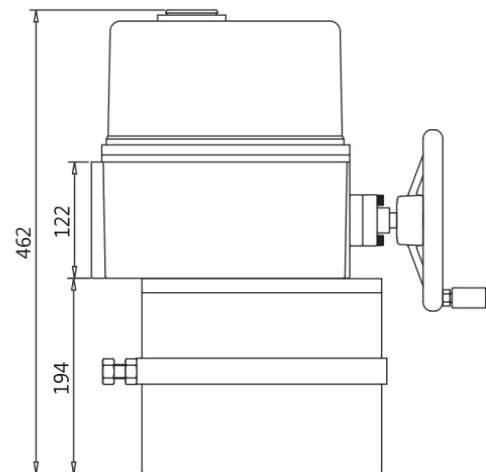
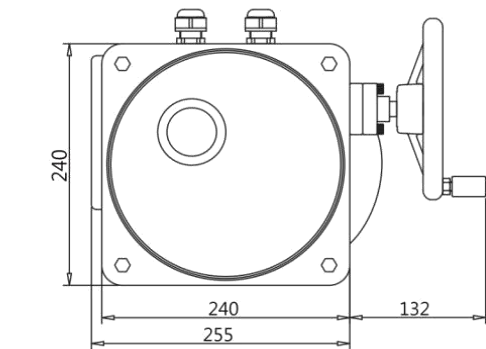

M16 x 165P.C.D
Mounting pattern is depending on valve

※For ordering actuator only, please provide transmission stem size of valve so as to connect actuator properly.



บริษัท เอดีดี เฟอร์เนส จำกัด

ADD FURNACE CO.,LTD.

44 ซอยบรมราชชนนี 70 ถนนบรมราชชนนี แขวงศาลาธรรมสพน์ เขตทวีวัฒนา กรุงเทพฯ 10170

โทร: 02-888-3472 โทร: ออกแบบ:08-08-170-170 แฟกซ์: 02-888-3258

https://www.add-furnace.com E-mail: sales@add-furnace.com

MIT-UNID-cns ELECTRIC ACTUATOR

UMB series For Gate Valve

General Description :

1. UM series lift actuator is applicable to up-and-down gate valve, ball valve, knife valve and bellow valve.
2. Bellows valve : 3/4" ~ 2 1/2" / Gate valve : 1 1/2" ~ 6"
ball valve : 1 1/2" ~ 6" / Knife valve : 2" ~ 6"
3. Travel : 20mm ~ 150mm
4. Standard voltage : Single-phase electric power 110VAC/220VAC
50/60Hz, three-phase electric power 220VAC/380VAC and 24VDC.
Special specification to be enquired.

Features :

1. Applicable for high temperature and high pressure environment.
2. Suitable for solid-state fluids, ex. Paper mill.
3. All Models have thermal protector.
4. Installable in a variety of environment as joints enclosed completely.
5. Equipped with valve position indicator on the side of actuator cover.
6. Equipped with Manual device for power failure.
7. Gate valve body made of stainless steel.

Enclosure :

1. IP67 rated waterproof and dustproof enclosure.
2. Main body made of molded aluminum alloy.
3. Housing is heat-resistant, acid and alkali-resistant and impact-resistant NYLON
4. Housing optional : Aluminum Alloy

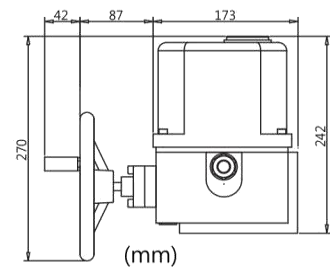

Action Interval : 15 minutes per travel

Micro-computer thermostatic controller

General Description :

Modulating motor thermostatic controller controls the opening of valve by temperature change.

Features :

1. Two PIDs control output.
2. Data lock function.
3. Applicable to all UM series.
4. Free power supply 85 ~ 265 VAC

Specification :

1. Power supply : 85 ~ 265 VAC 50/60Hz
2. Memory element : EEPROM
3. Operation condition : Celsius degree
0 ~ 50°C , 35 ~ 85% RH
4. Storage Environment : Celsius degree
-25 ~ 65°C , 35 ~ 85%





บริษัท เอดีดี เฟอร์เนส จำกัด

ADD FURNACE CO.,LTD.

44 ซอยบรมราชชนนี 70 ถนนบรมราชชนนี แขวงศาลาธรรมสพน์ เขตทวีวัฒนา กรุงเทพฯ 10170

โทร: 02-888-3472 โทร: ออกแบบ:08-08-170-170 แฟกซ์: 02-888-3258

https://www.add-furnace.com E-mail: sales@add-furnace.com

ELECTRIC ACTUATOR miT-uniD-cns

UM Modulating Series

Modulating Controller

General Description :

1. Modulating controller suitable for UM-1 ~ UM-12
2. Modulating controller proportionally controls the opening of valve
3. UM-1 ~ UM-2 install extra box; UM-3 ~ UM-12 install inside

Specification :

Power requirement : 100VAC ~ 120VAC ; 200VAC ~ 250VAC

Signal input : 4 ~ 20mA, 2 ~ 10VDC

Signal output : 4 ~ 20mA, and either 1 ~ 5VDC or 2 ~ 10VDC

Signal input/output adjustable as request, ex : 0 ~ 10VDC, 1 ~ 5VDC, 0 ~ 20mA

Features :

1. Position indication : Armed and displaying for valve opening.
2. Waterproof joints : Installable in a variety of environment as joints enclosed completely.
3. Manual device : UM3-1 ~ UM-12 armed with hand wheel and available in case of power cut.
4. Thermostatic control available.
5. Signal output adjustable and tolerable at ± 1 mA.
6. With filtering, diminishable to the influence of EMI and EMC.

Signal input :

1. DIP SWITCH provides 4 ~ 20mA, 2 ~ 10VDC modes.
2. The input signal can control the opening of the valve by current or voltage

Enclosure :

1. IP67 rated waterproof and dustproof enclosure
2. Housing is heat-resistant, acid and alkali-resistant and impact-resistant NYLON

Working environment :

-10°C ~ 60°C

Cautions :

1. Make sure that the voltage, temperature, pressure, fluid type and other characteristics in locality (ex. Providing voltage unstable, stabilizer required)
2. For avoidance of signal interference, transmit signal with shielded cable and set apart with power supply, avert entangling together.

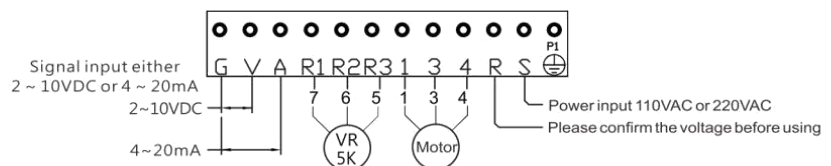
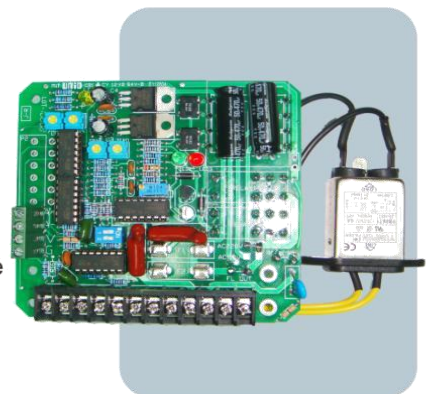



บริษัท เอดีดี เฟอร์เนส จำกัด

ADD FURNACE CO.,LTD.

44 ซอยบรมราชชนนี 70 ถนนบรมราชชนนี แขวงศาลาธรรมสพน์ เขตทวีวัฒนา กรุงเทพฯ 10170

โทร: 02-888-3472 โทร: ออกแบบ:08-08-170-170 แฟกซ์: 02-888-3258

https://www.add-furnace.com E-mail: sales@add-furnace.com

miT-UNID[®]-cns ELECTRIC ACTUATOR

1sec Electric Actuator Series

Quick Open / Close Electric Actuator Series

Specification :

Power requirement: 100VAC ~ 120VAC
200VAC ~ 250VAC
24VDC

UM-1 quick close time: AC 1 sec, 5 sec / DC 2 sec

UM-1 quick open time: AC 1sec, 5 sec / DC 2sec

*UM-1 5sec customizable with modulator

UM-3 ~ UM-3-1 quick close time: AC 1 sec / DC 1 sec

UM-3 ~ UM-3-1 quick open time: AC 1 sec / DC 1 sec

Pressure applicable to 10 Kg/cm²



Features :

1. Quick open / close
2. Position indication: Armed for valve opening upon all UM series
3. Waterproof joints: Installable in a variety of environment as joints enclosed completely, rated Ip67
4. Manual device: Armed and available in case of power cut in all UM series
5. Open / close speed replaceable for pneumatic electric actuator, no need to take on air compressor

Enclosure :

1. IP67 rated waterproof and dustproof enclosure
2. Main body made of nylon or molded aluminum alloy

Cautions :

1. Please turn power off before manual operation or for maintenance to avoid parts broken or danger. When manual operating, 8m/m (not exceeding 10cm) open end wrench, is recommended to use. Turn slightly firstly, and check whether it is turned too tightly to avoid valve deadlocked. Do not turn it brutally to prevent internal machine parts broken or damage.
Note: Do not use other tool to turn hand wheel, otherwise it will damage motor and valve.
2. Check waterproof O Ring and cable gland are secured tightly after wiring to prevent dusting or water contamination.
(Suggested Minimum wire thickness is above 6Ø)
3. When more than one electric actuator is needed to operate simultaneously, please connect with the individual cables or installing independent relay for each actuator.
4. When manual operating, please note the position indicator can not exceed scale marking range to prevent internal machine parts damage. (Modulator: Variable resistor impaired)

Working environment :

-10°C ~ 60°C

Valve application :

Available to all kinds of valves

Electric actuator specification for 1sec, 2sec, 5sec

Screw End	Flange Ends	Butterfly Valve	PVC	3-Way Valve
1/4" ~ 2"	1/2" ~ 2"	2" ~ 3"	1/2" ~ 2"	1/2" ~ 2"

*Above valve body is form our company. If you have special requirement, please contact us.



บริษัท เอดีดี เฟอร์เนส จำกัด

ADD FURNACE CO.,LTD.

44 ซอยบรมราชชนนี 70 ถนนบรมราชชนนี แขวงศาลาธรรมสพน์ เขตทวีวัฒนา กรุงเทพฯ 10170

โทร: 02-888-3472 โทร: ออกแบบ:08-08-170-170 แฟกซ์: 02-888-3258

https://www.add-furnace.com E-mail: sales@add-furnace.com

ELECTRIC ACTUATOR **miT-uniD**-cns

Standard Instructions of Hook-up

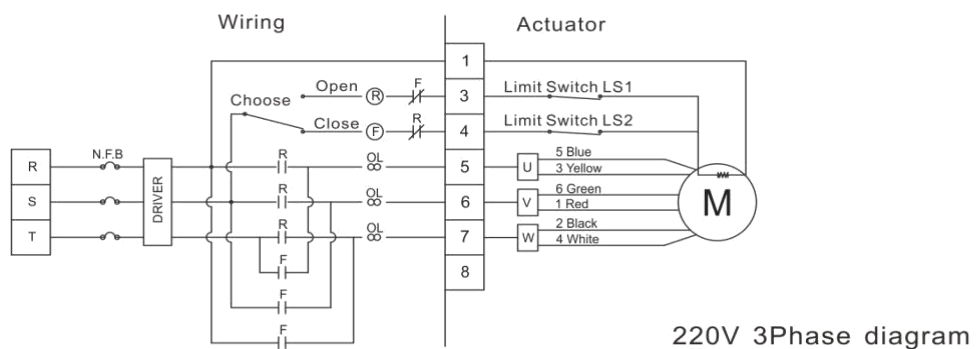
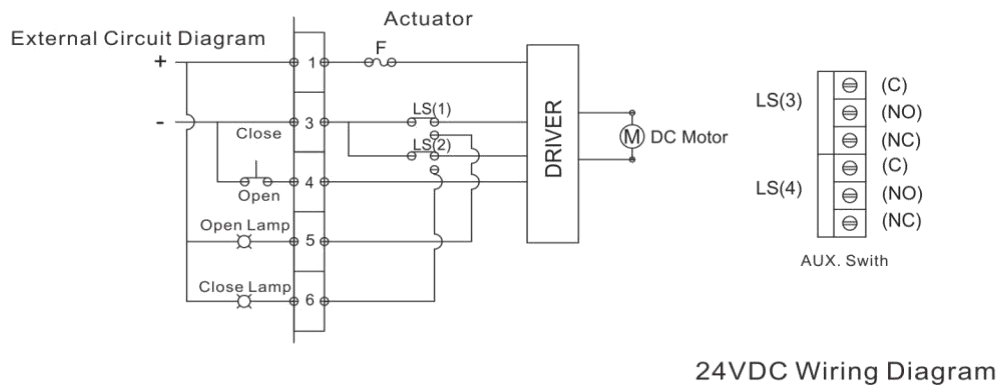
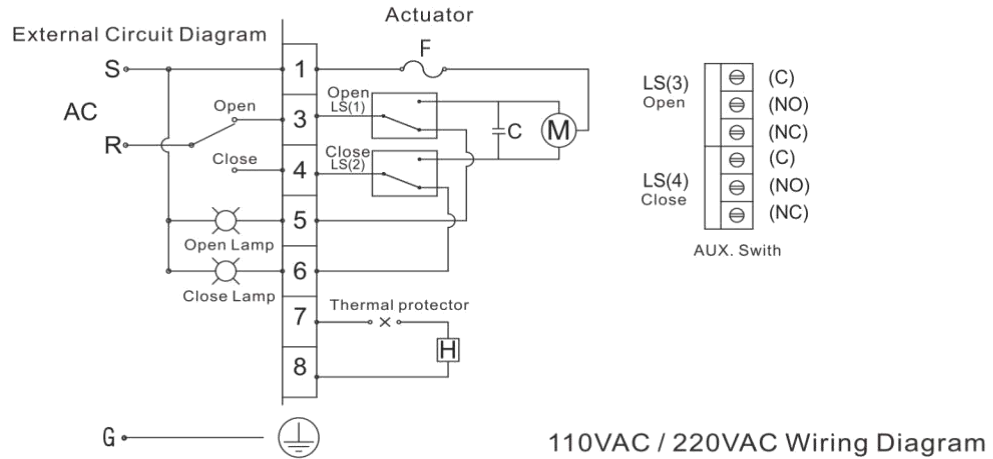

3-Way Valve Dimension

	3WAY-3PORT T TYPE				3WAY-3PORT L TYPE
	Set 1	Set 2	Set 3	Set 4	Set 5
Direction (open)					
Direction (shut)					



บริษัท เอดีดี เฟอร์เนส จำกัด

ADD FURNACE CO.,LTD.

44 ซอยบรมราชชนนี 70 ถนนบรมราชชนนี แขวงศาลาธรรมสพน์ เขตทวีวัฒนา กรุงเทพฯ 10170

โทร: 02-888-3472 โทร: ออกแบบ:08-08-170-170 แฟกซ์: 02-888-3258

https://www.add-furnace.com E-mail: sales@add-furnace.com

miT-uniD-cns ELECTRIC ACTUATOR

Actuator Wiring Diagram

Actuator Wiring Diagram 110/220VAC

(One switch parallel connection wiring)

3 sets of actuator operated with 1 switch, 2 on and 1 off

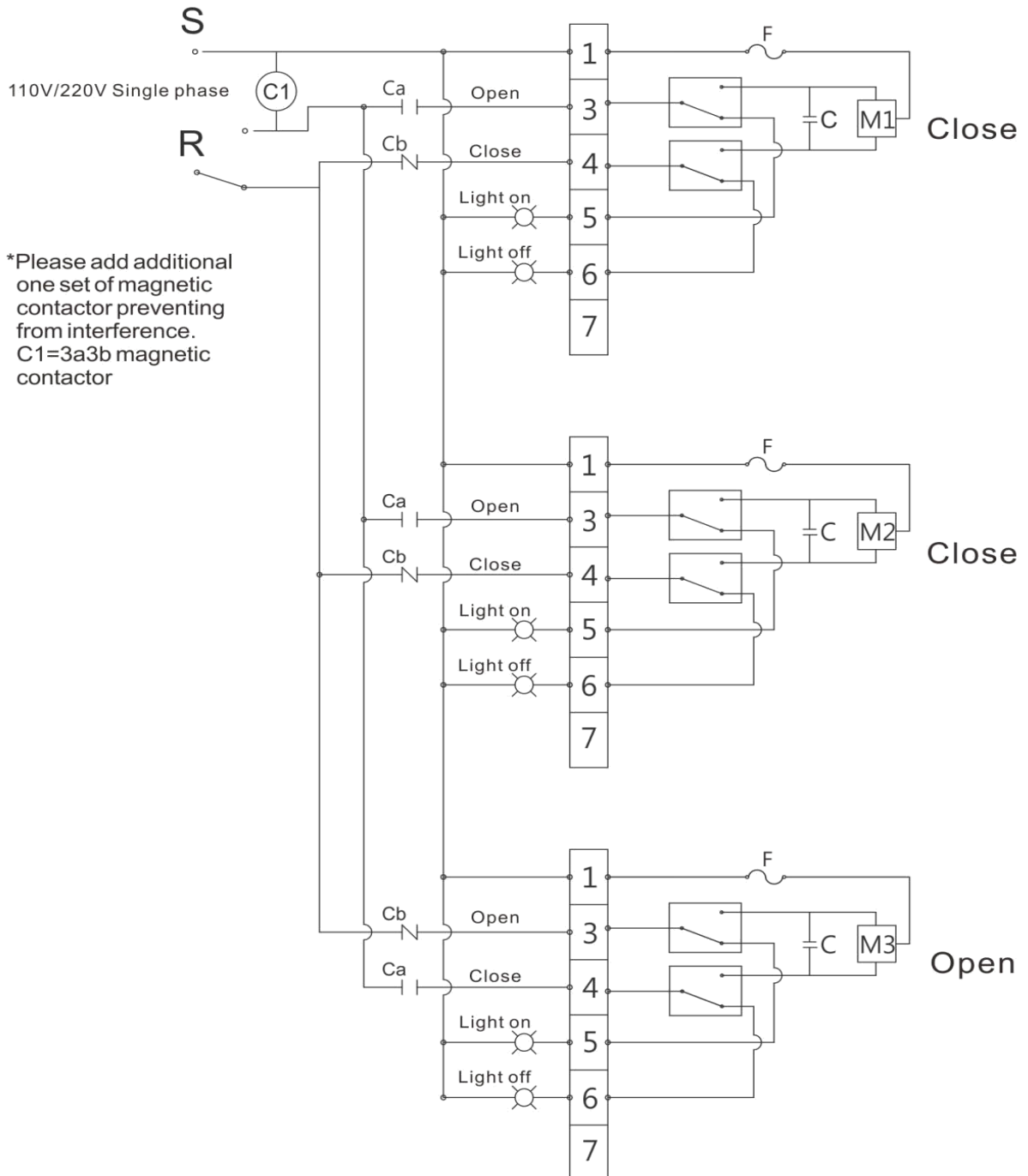



บริษัท เอดีดี เฟอร์เนส จำกัด

ADD FURNACE CO.,LTD.

44 ซอยบรมราชชนนี 70 ถนนบรมราชชนนี แขวงศาลาธรรมสพน์ เขตทวีวัฒนา กรุงเทพฯ 10170

โทร: 02-888-3472 โทร: ออกแบบ:08-08-170-170 แฟกซ์: 02-888-3258

https://www.add-furnace.com E-mail: sales@add-furnace.com

ELECTRIC ACTUATOR mit-uniD-cns

Actuator Wiring Diagram

AC modulation wiring diagram

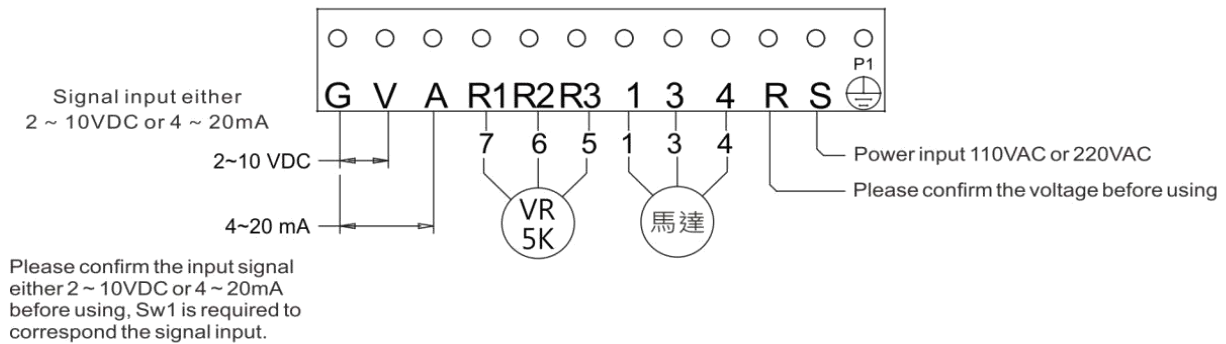

90VAC - 240VAC multi-voltage modulation wiring diagram

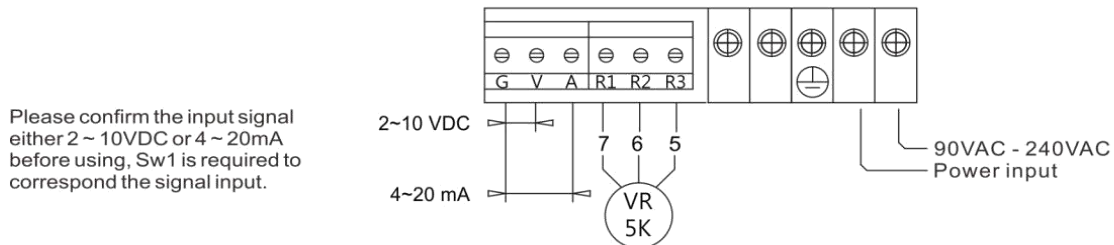

DC modulation wiring diagram

